



To: All Plan Holders of Record

From: CT Consultants, Inc.
For the Owner

Re: *Addendum No. 1*
Roosevelt Park – Bocce Court
City of Campbell

Date: April 8, 2020

With this letter I hereby acknowledge receipt of Addendum 1. In acknowledgement of the Addendum I understand this Addendum forms a part of the contract documents and modifies the original bidding documents dated March 2020 and all previous addenda, if any.

BID OPENING DATE

The bid opening date shall be changed from April 9, 2020 to April 23, 2020. The time and place of opening shall remain the same.

PLANS

Delete and Replace: Drawing A-01, Plans and Details with revised sheet dated 4/2/2020.

QUESTIONS AND ANSWERS

Q1) What materials and specifications should be used for the water service line?

A1) 1. WATER SERVICE LINE:

- a. SHALL BE TYPE K COPPER COMPLYING WITH ASTM B88, STANDARD SPECIFICATION FOR SEAMLESS COPPER WATER TUBE.
- b. SHALL BE LAID AT A DEPTH OF NOT LESS THAN 4 FEET 6 INCHES NOR MORE THAN 5 FEET BELOW FINISHED GROUND LEVEL.

2. VALVES AND FITTINGS FOR WATER SERVICE LINE: SHALL COMPLY WITH AWWA C800, UNDERGROUND SERVICE LINE VALVES AND FITTINGS.

3. TAPPING SLEEVES AND VALVES:

- a. AWWA C223, FABRICATED STAINLESS STEEL TAPPING SLEEVES
- b. STAINLESS STEEL WITH MJ OUTLET, AS MANUFACTURED BY SMITH-BLAIR OR EQUAL
- c. RATED AT 200 PSI WORKING PRESSURE COMPLYING WITH AWWA C500. VALVES SHALL HAVE RESILIENT SEATS.

JSS/PAW:mep

Enclosure

H:\2019\190901\SPEC\Addenda\Addendum 01\Addendum 1.Doc

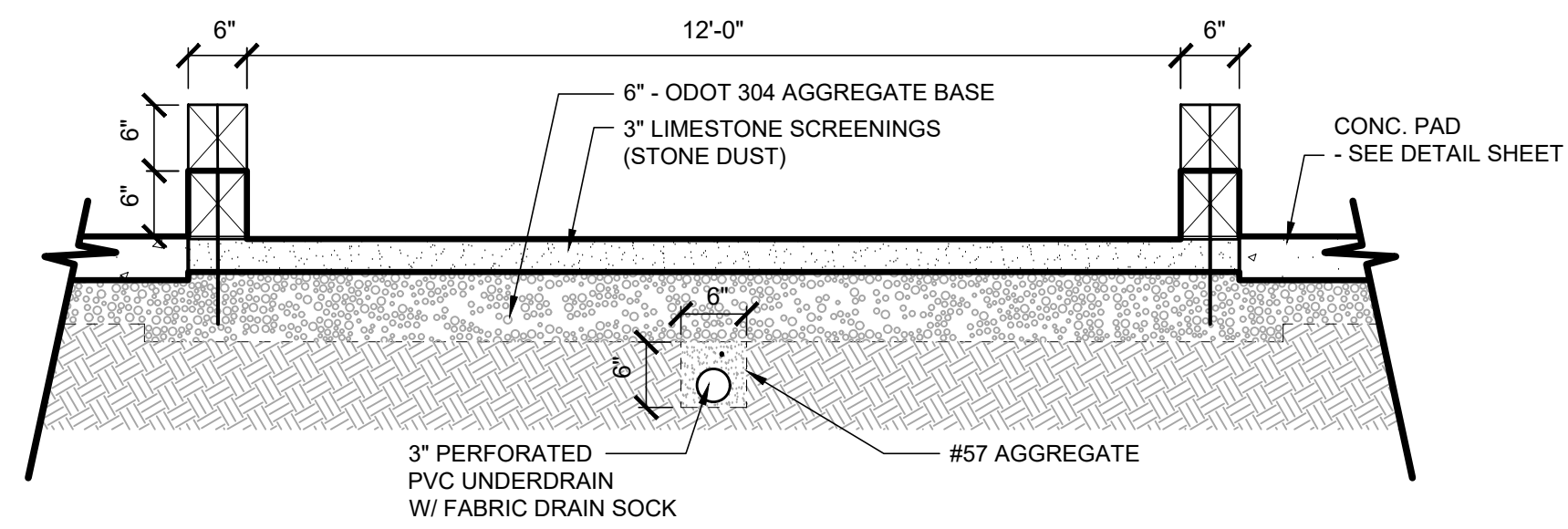

BOCCE COURT SECTION
SCALE: 3/4" = 1'-0"
1 A-01

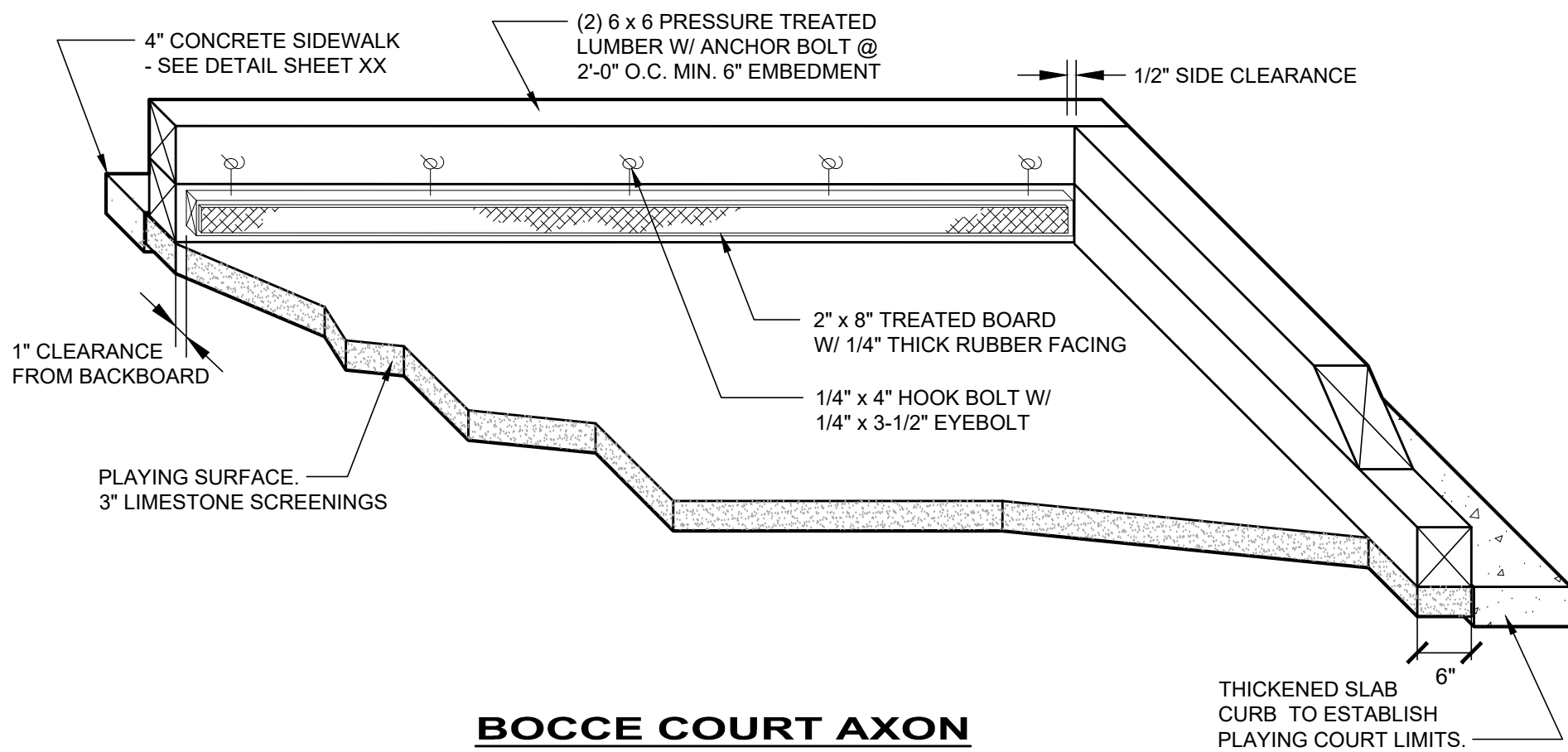

BOCCE COURT AXON
SCALE: 3/4" = 1'-0"

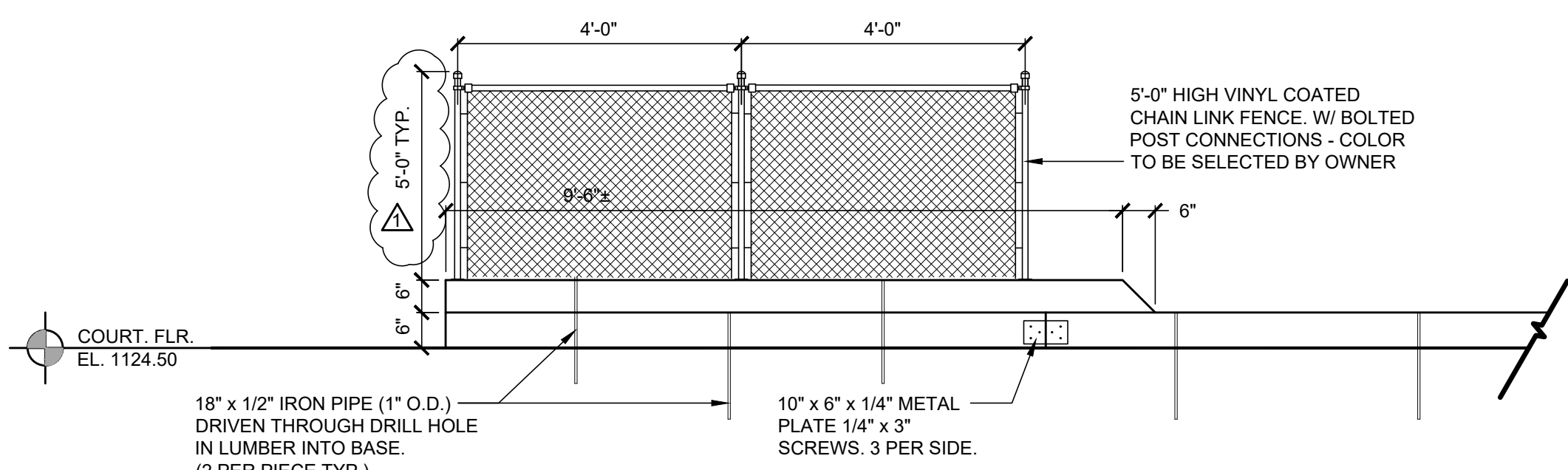

BOCCE COURT SIDE ELEVATION
SCALE: 1/2" = 1'-0"

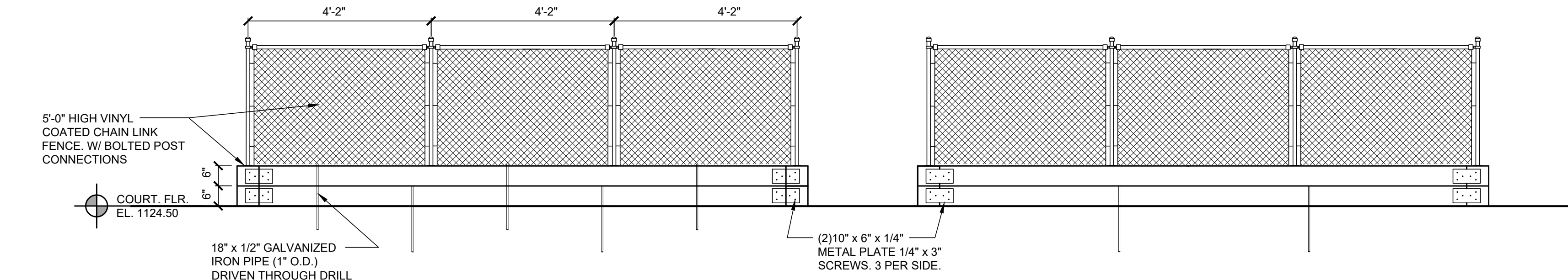

BOCCE COURT END ELEVATION
SCALE: 1/2" = 1'-0"

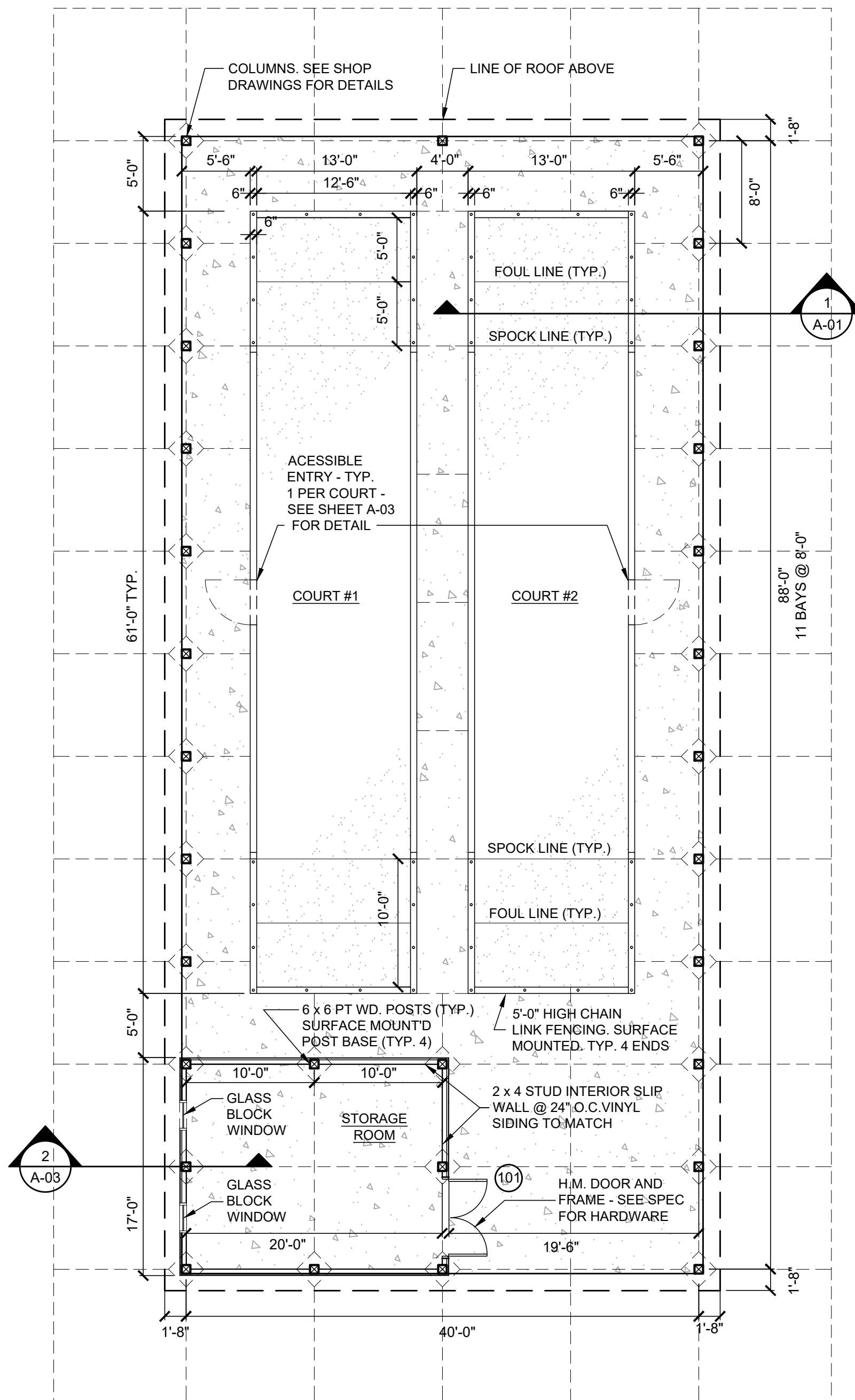

FLOOR PLAN
SCALE: 1/16" = 1'-0"

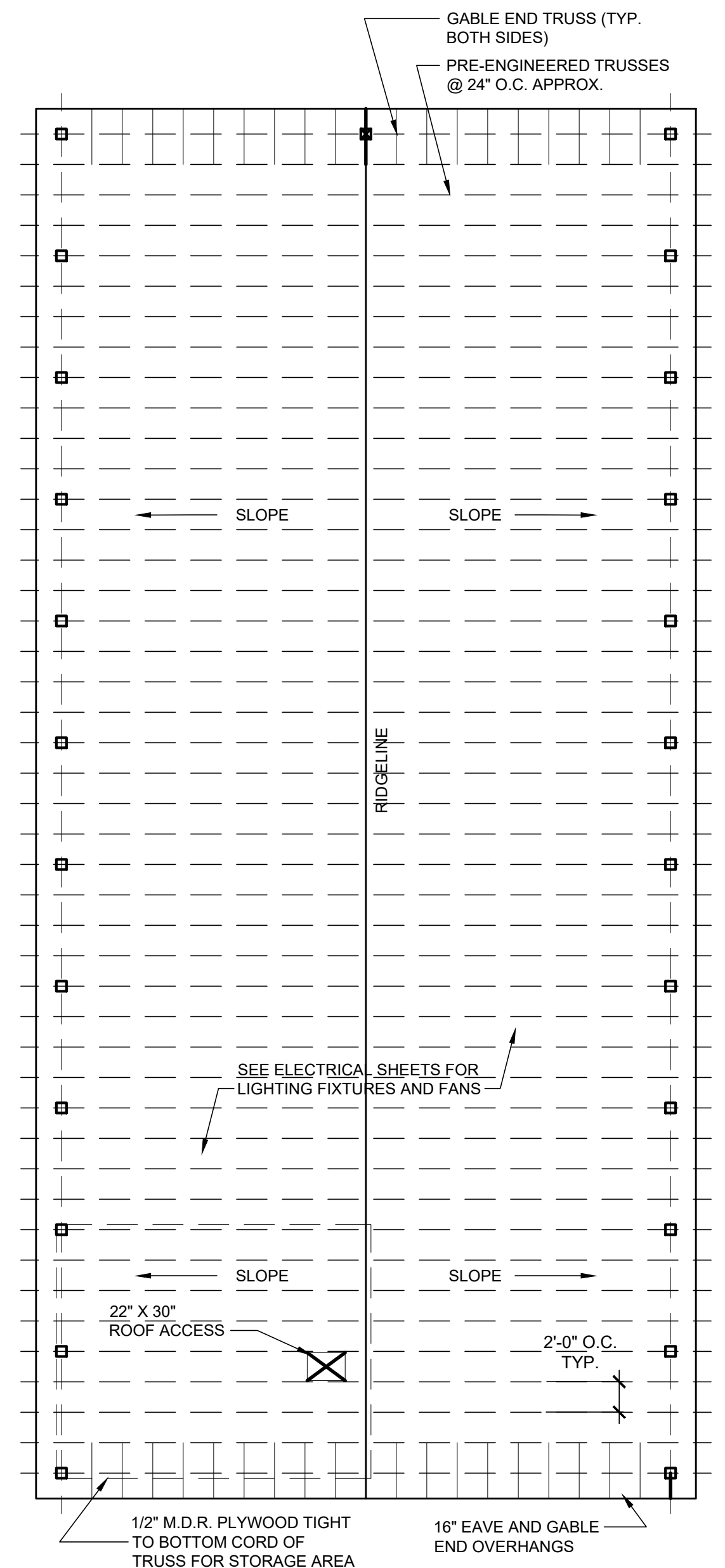

ROOF PLAN
SCALE: 1/16" = 1'-0"

GENERAL NOTES:

1. CONTRACTOR TO FIELD VERIFY ALL DIMENSIONS AND EXISTING CONDITIONS BEFORE SUBMITTING A BID PROPOSAL. DELETIONS FROM DRAWINGS WILL NOT BE ACCEPTED AS JUST CAUSE FOR CHANGING THE CONTRACT COST. DRAWINGS ARE INTENDED TO SHOW AREAS OF WORK AND DESIGN INTENT ONLY.
2. CONTRACTOR IS RESPONSIBLE FOR ALL SECURITY AND WEATHER-PROOFING RELATED ITEMS DURING CONSTRUCTION. INTENDED MATERIALS AND COURT SYSTEM MUST BE APPROVED BY ARCHITECT. ANY DAMAGE TO EXISTING STRUCTURE OR INTERIOR DUE TO NEGLIGENCE MUST BE REPAIRED BY THE CONTRACTOR.
3. CONTRACTOR TO MAINTAIN SITE IN A NEAT AND ORDERLY MANNER FOR EXTENT OF CONSTRUCTION.
4. CONTRACTOR TO TAKE SPECIAL PRECAUTIONS NOT TO DAMAGE THE SURROUNDING SITE AND EXISTING STRUCTURES DURING CONSTRUCTION. CONTRACTOR TO NOTIFY ARCHITECT PRIOR TO THE START OF THE REPAIR WORK AND DOCUMENT ALL AREAS THAT MAY BE IN QUESTION. CONTRACTOR TO REPAIR ALL AREAS DAMAGED AT NO ADDITIONAL COST TO OWNER.

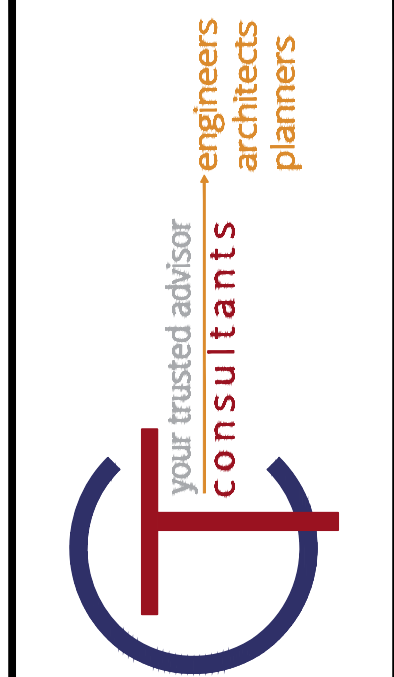
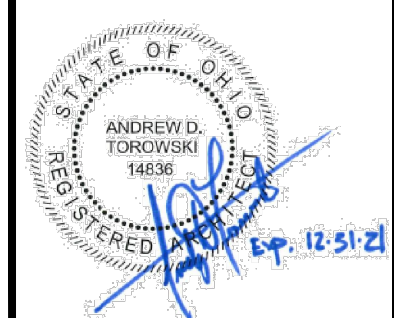

ISSUED FOR:	BID	ISSUE DATE:	SCALE:	DESIGNED BY:	PAW	DRAWN BY:	PAW	CHECKED BY:	ADT
REVISIONS	DESCRIPTION	DATE	REVISIONS	DESCRIPTION	DATE	REVISIONS	DESCRIPTION	DATE	REVISIONS
1	ADDITIONAL 1 - COURT DETAIL CLARIFICATION	4/22/2020							

CITY OF CAMPBELL
BOCCE COURTS AND PAVILION
CAMPBELL, OHIO
MAHONING COUNTY
PLANS AND DETAILS

PROJECT NO.	190901
DISCIPLINE	ARCHITECTURAL
SHEET NAME	A-01
SHEET	OF
5	9