

# VILLAGE OF LOWELLVILLE

## WEST WOOD STREET

### IMPROVEMENTS PROJECT

#### LOWELLVILLE, OHIO

##### OPWC PROJECT No. CT28W

BID SET

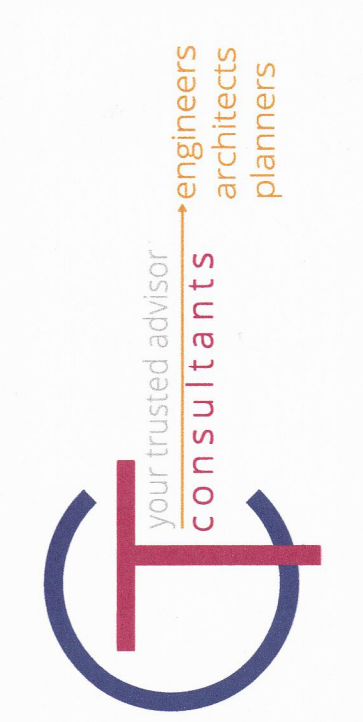
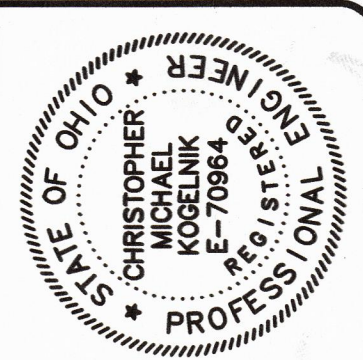

ISSUED FOR:	BID SET	NO	REVISION	DATE
ISSUE DATE:	07/19/2019			
SCALE:	AS SHOWN			
DESIGNED BY:	EMS			
DRAWN BY:	EMS			
CHECKED BY:	CHK			

INDEX OF SHEETS	
SHEET NUMBER	SHEET TITLE
01	COVER SHEET
02	GENERAL NOTES - 01
03	LEGEND & SYMBOLOGY
04	CONSTRUCTION DETAILS - 01
05	CONSTRUCTION DETAILS - 02
06	SURVEY CONTROL PLAN
07	EXISTING CONDITIONS
08	SITE IMPROVEMENTS - 01
09	SITE IMPROVEMENTS - 02
10	SITE IMPROVEMENTS - 03
11	SITE IMPROVEMENTS - 04

JULY, 2019

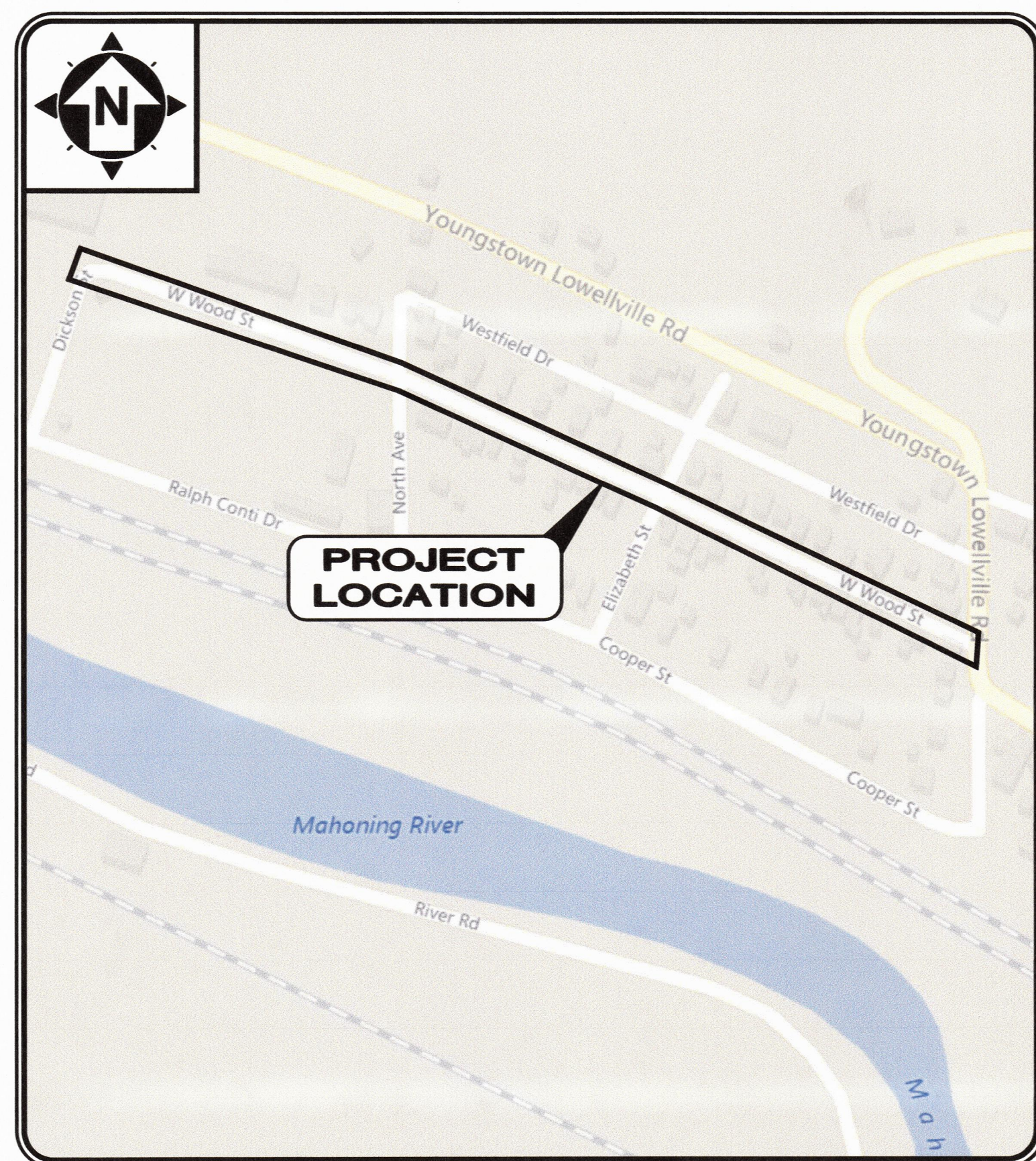

**LOCATION MAP**  
NOT TO SCALE

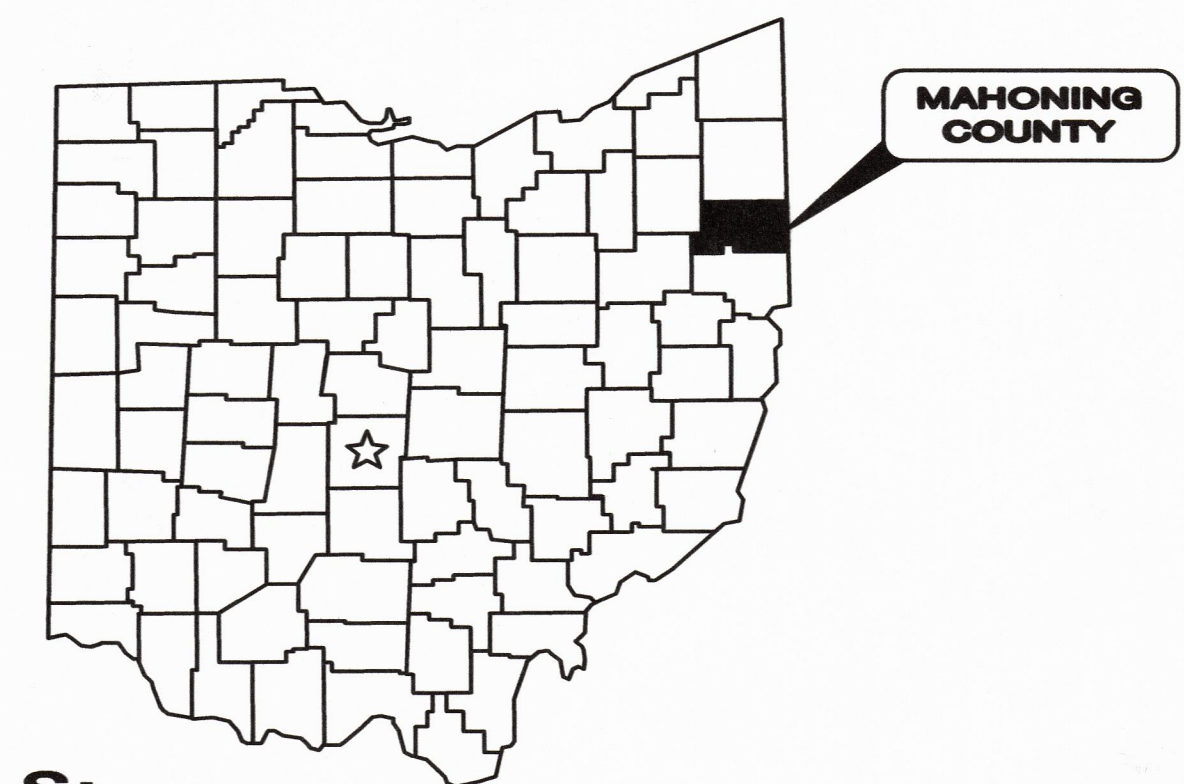

**APPROVALS:**

	MAYOR	JAMES IUDICIANI, SR.	7/23/19	DATE
	VILLAGE ADMINISTRATOR	RICHARD DAY	7/23/19	DATE
	CLERK TREASURER	CAROL FLORA	7/23/19	DATE

**COUNCIL MEMBERS:**

- ROBERT COPPOLA
- DON D'ONOFRIO
- VAN ESENWEIN
- WILLIAM FLORA
- KEITH McCAGHTRY
- RONALD ROTUNNO

**PLANS PREPARED BY:**

	CHRISTOPHER M. KOGELNIK, P.E.	7/19/19	DATE
--	-------------------------------	---------	------

**OUPS DESIGN SERIAL NUMBERS:**

B903900405-008

**OUPS UTILITY LIST:**

- |             |   |                    |
|-------------|---|--------------------|
| 1. WATER    | - | AQUA OHIO          |
| 2. GAS      | - | DOMINION EAST OHIO |
| 3. PHONE    | - | AT&T               |
| 4. FIBER    | - | CENTURYLINK        |
| 5. FIBER    | - | CHARTER            |
| 6. ELECTRIC | - | OHIO EDISON        |



- UNDERGROUND BUILDING SERVICE UTILITY LINES ARE NOT SHOWN ON THE PLANS. THE CONTRACTOR SHALL BE RESPONSIBLE FOR LOCATING, MAINTAINING AND REPLACING AS NECESSARY TO ENSURE CONTINUAL SERVICE TO BUILDINGS.
- THE CONTRACTOR IS RESPONSIBLE TO CALL OHIO UTILITIES PROTECTION SERVICE @ 1-800-362-2764, THREE WORKING DAYS PRIOR TO CONSTRUCTION.
- THE CONTRACTOR IS RESPONSIBLE TO COORDINATE THEIR EFFORTS WITH THE LISTED OUPS ONE CALL UTILITIES AS WELL AS ANY ENCOUNTERED UTILITIES THAT MAY BE UNLISTED.



20 FEDERAL PLAZA WEST SUITE 303 | YOUNGSTOWN, OHIO 44503 | PHONE: 330-746-1200

**ENGINEER'S PROJECT No. 190074**

**VILLAGE OF LOWELLVILLE**  
WEST WOOD STREET  
IMPROVEMENTS PROJECT  
LOWELLVILLE MAHONING COUNTY  
**COVER SHEET**

PROJECT NO. 190074  
DISCIPLINE GENERAL  
SHEET NAME CS  
SHEET 01 OF 11

## GENERAL:

- ANY REVISIONS TO THE ACCEPTED CONSTRUCTION PLANS SHALL BE REVIEWED AND APPROVED BY THE ENGINEER PRIOR TO IMPLEMENTATION IN THE FIELD.
- THE CONTRACTOR SHALL BE RESPONSIBLE FOR ALL CONSTRUCTION LAYOUT AND SHALL NOTIFY THE ENGINEER, IN WRITING, OF ANY DISCREPANCIES.
- NO WORK SHALL COMMENCE WITHOUT AN EXECUTED NOTICE TO PROCEED.
- THE CONTRACTOR SHALL BE SOLELY RESPONSIBLE FOR COMPLYING WITH OSHA SAFETY REQUIREMENTS. THE CONTRACTOR SHALL BE RESPONSIBLE FOR THE SAFETY OF ALL VISITORS, EMPLOYEES AND WORKERS ON THE CONSTRUCTION SITE.
- THE CONTRACTOR SHALL CONSTRUCT THIS PROJECT IN COMPLIANCE WITH FEDERAL, STATE AND LOCAL BUILDING CODES.
- ALL EXCAVATIONS ARE TO BE SECURED AND PROTECTED AT ALL TIMES.
- ALL SEDIMENT AND EROSION CONTROL PRACTICES SHALL BE INSTALLED PRIOR TO ANY MAJOR SOIL DISTURBANCE IN THEIR PROPER SEQUENCE AND MAINTAINED UNTIL PERMANENT PROTECTION IS ESTABLISHED.
- ANY DISTURBED AREAS NOT SCHEDULED FOR CONSTRUCTION ACTIVITIES WITHIN 14 DAYS OF DISTURBANCE SHALL BE TEMPORARILY STABILIZED.
- THE CONTRACTOR SHALL WORK WITHIN DESIGNATED STREET RIGHTS-OF-WAY, UTILITY EASEMENTS, AND CONSTRUCTION EASEMENTS WHILE CONSTRUCTING THIS PROJECT UNLESS OTHERWISE DIRECTED BY THE ENGINEER. THE CONTRACTOR SHALL MINIMIZE LAND AND PROPERTY DISTURBANCE WITHIN SAID RIGHTS-OF-WAY AND EASEMENTS.
- THE CONTRACTOR SHALL PRESERVE ALL CORNERSTONES, IRON PINS, CONCRETE MONUMENTS, OR ANY OTHER TYPE OF LAND MONUMENT. THE CONTRACTOR SHALL HAVE ALL MONUMENTS IN THE PROXIMITY OF THE WORK REFERENCED. THE CONTRACTOR SHALL REPLACE DESTROYED OR DISTURBED LAND MONUMENTS AND SHALL FURNISH A CERTIFICATION BY AN OHIO REGISTERED SURVEYOR THAT THE MONUMENTS HAVE BEEN RESTORED.
- ALL POLLUTANTS OTHER THAN SEDIMENT THAT OCCUR ON-SITE DURING CONSTRUCTION SHALL BE HANDLED AND LEGALLY DISPOSED OF IN A MANNER THAT DOES NOT CAUSE CONTAMINATION OF STORM OR SURFACE WATERS. POLLUTANTS OF CONCERN INCLUDE, BUT ARE NOT LIMITED TO, FUELS, LUBRICANTS, SOLVENTS, CONCRETE BI-PRODUCTS AND CONSTRUCTION MATERIALS.
- THE CONTRACTOR SHALL BE SOLELY RESPONSIBLE FOR THE SECURITY OF ALL STORED MATERIALS.
- AT LEAST FIVE DAYS PRIOR TO THE START OF ACTUAL CONSTRUCTION WORK, A PRE-CONSTRUCTION CONFERENCE WILL BE HELD AT A TIME MUTUALLY AGREEABLE TO THE PARTICIPANTS. THE PROJECT ENGINEER, APPROPRIATE VILLAGE, TOWNSHIP, AND COUNTY OFFICIALS, THE CONTRACTOR, AND REPRESENTATIVES OF THE UTILITY COMPANIES SHALL ATTEND THE MEETING.
- CONTRACTOR IS REQUIRED TO SUBMIT A COMPREHENSIVE WORK SCHEDULE AT THE PRE-CONSTRUCTION MEETING FOR REVIEW AND APPROVAL BY THE OWNER.
- THE CONTRACTOR SHALL NOT COMMENCE WITH ANY FORM OF CONSTRUCTION WITHOUT CONTACTING CT CONSULTANTS, INC. (330) 746-1200 A MINIMUM OF 48 HOURS IN ADVANCE OF CONSTRUCTION ACTIVITY TO ARRANGE FOR OBSERVATION. IF ANY CHANGE IN WORK SCHEDULE BECOMES NECESSARY, IT WILL BE THE RESPONSIBILITY OF THE CONTRACTOR TO CONTACT CT CONSULTANTS, INC. TO AVOID UNNECESSARY OBSERVATION COSTS. IF NO NOTIFICATION IS MADE IN REGARDS TO CANCELLATION OF WORK, THE CONTRACTOR WILL BE CHARGED FOR THE TIME INCURRED.
- ALL CONSTRUCTION ACTIVITIES SHALL BE PERFORMED FROM 7:30 A.M. TO 7:30 P.M. MONDAY THROUGH FRIDAY, UNLESS OTHERWISE APPROVED BY THE MUNICIPALITY AND THE ENGINEER.
- AS BUILT RECORDS - THE CONTRACTOR SHALL BE RESPONSIBLE FOR MAINTAINING A SET OF PROJECT RECORD DOCUMENTS. THESE DOCUMENTS SHALL INCLUDE REVIEWED SHOP DRAWINGS, CHANGE ORDERS, EQUIPMENT OPERATING INSTRUCTIONS, FIELD TEST RECORDS, AND AS BUILT DRAWINGS. THE AS BUILT DRAWINGS SHALL BE MARKED LEGIBLY IN RED WITH THE ACTUAL LOCATION OF EQUIPMENT AND CONDUITS AS CONSTRUCTED. ALL EQUIPMENT AND UNDERGROUND CONDUITS INSTALLED SHALL HAVE LOCATIONS MARKED IN DISTANCE OFF A LANDMARK AT LEAST EVERY 25 FEET AND AS NECESSARY AT BENDS FOR LOCATION OF A LATER DATE. FINAL DOCUMENTS AND PLANS SHALL BE DELIVERED TO THE OWNER. THE CONTRACTOR SHALL SUBMIT RECORD DRAWINGS TO THE ENGINEER WITHIN 30 CALENDAR DAYS OF THE ISSUANCE OF THE CERTIFICATION OF SUBSTANTIAL COMPLETION OR PRIOR TO THE SUBMISSION OF THE FINAL PAYMENT APPLICATION, WHICH EVER OCCURS FIRST.

## ODOT SPECIFICATIONS:

- THE "CONSTRUCTION AND MATERIAL SPECIFICATIONS" OF THE STATE OF OHIO DEPARTMENT OF TRANSPORTATION (ODOT), LATEST EDITION, CURRENT ODOT SUPPLEMENTAL SPECIFICATIONS, AND CURRENT ODOT STANDARD DRAWINGS SHALL GOVERN WORK AND MATERIALS WHICH ARE NOT SPECIFIED OR MODIFIED HEREIN OR ON THE PROJECT CONTRACT DRAWINGS. ALL REFERENCES TO "THE DEPARTMENT" SHALL BE CHANGED TO "THE OWNER OR HIS REPRESENTATIVE." THE PROJECT CONTRACT DRAWINGS AND SPECIFICATIONS, IN THE EVENT OF A DISCREPANCY, SHALL SUPERSEDE THE ODOT SPECIFICATIONS.
- THE ABSENCE OF AN "AS PER PLAN" DESIGNATION ON SOME ITEM DESCRIPTIONS IN THE PROPOSAL FOR WHICH THERE ARE CLEAR AND CONTROLLING PLAN NOTES, SPECIFICATIONS, OR OTHER REQUIREMENTS DOES NOT RELIEVE THE CONTRACTOR OF THE RESPONSIBILITY TO READ, BID AND CONSTRUCT THOSE PARTICULAR ITEMS IN ACCORDANCE WITH THE GOVERNING PLAN NOTES, SPECIFICATIONS, OR OTHER REQUIREMENTS AND THE CONTRACTOR SHALL HAVE NO BASIS OF CLAIM BASED UPON AN "ORDER OF PRECEDENCE".

## EXISTING CONDITIONS:

- SHOULD IT BECOME NECESSARY TO CHANGE THE POSITION OR TEMPORARILY REMOVE ANY STORM DRAIN, SANITARY SEWER, ELECTRIC CONDUITS, WATER PIPES, GAS PIPES, PROCESS OR OTHER PIPES OR WIRES IN ORDER TO PERMIT THE CONTRACTOR TO USE A PARTICULAR METHOD OF CONSTRUCTION OR IN ORDER TO CLEAR THE STRUCTURES BEING BUILT, THE CONTRACTOR SHALL NOTIFY THE ENGINEER OF THE LOCATION AND CIRCUMSTANCES AND SHALL CEASE WORK, IF NECESSARY, UNTIL SATISFACTORY ARRANGEMENTS HAVE BEEN MADE BY THE OWNERS OF SAID PIPES OR WIRES TO PROPERLY CARE FOR THE SAME. NO CLAIMS FOR DAMAGES WILL BE ALLOWED ON ACCOUNT OF ANY DELAY OCCASIONED THEREBY. THE ENTIRE COST OF THE CHANGES OR TEMPORARY REMOVAL MUST BE INCLUDED IN THE PRICES STIPULATED FOR THE VARIOUS ITEMS OF WORK TO BE DONE UNDER THIS CONTRACT.

## PROTECTION OF THE PUBLIC:

- THE CONTRACTOR IS RESPONSIBLE FOR THE PROTECTION OF THE PUBLIC FROM ANY HAZARDS CAUSED BY THE CONSTRUCTION OF THIS PROJECT. THE CONTRACTOR SHALL PROVIDE SIGNS, BARRICADES, FENCING, PLATES, COVERS, ETC. NEEDED TO PROVIDE THIS PROTECTION. THE CONTRACTOR SHALL COMPLY WITH ALL FEDERAL, STATE, AND LOCAL LAWS AND REGULATIONS WITH RESPECT TO PROTECTING THE PUBLIC.

## DUST CONTROL:

- MATERIALS AND EQUIPMENT, SUCH AS WATER, ARE TO BE PROVIDED BY THE CONTRACTOR FOR USE AS DUST CONTROL, AS DIRECTED BY THE ENGINEER. NO SEPARATE PAYMENT WILL BE MADE.
- THE CONTRACTOR SHALL SUPPLY ALL NECESSARY LABOR, MATERIALS, AND EQUIPMENT SUCH AS CALCIUM CHLORIDE (IF NECESSARY), WATER, OR A MOTORIZED DUST-FREE STREET SWEEPING DEVICE, AS APPROVED BY THE ENGINEER, TO MINIMIZE DUST GENERATED ON THE CONSTRUCTION SITE AND TO MAINTAIN ALL ROADWAYS BEING USED FOR ACCESS TO THE CONSTRUCTION SITE.

## EXISTING UTILITIES:

- THE LOCATIONS OF THE UNDERGROUND UTILITIES ARE PLOTTED ACCORDING TO THE INFORMATION FURNISHED BY THE UTILITIES CONCERNED AND THE OWNER DOES NOT GUARANTEE THE ACCURACY THEREOF. CONTRACTOR TO CALL OUPS (1-800-362-2764) \*48 HOURS BEFORE YOU DIG\* AND CALL OIL & GAS PRODUCERS PROTECTIVE (1-800-925-0988). CONTRACTOR ALSO TO COORDINATE HIS WORK WITH THE UTILITIES LISTED ON THIS SHEET.
- IN THE EVENT OF DAMAGE TO EXISTING PUBLIC AND/OR PRIVATE UTILITIES, THE AGENCY CONCERNED SHALL BE NOTIFIED IMMEDIATELY AND ALL REPAIR WORK SHALL BE EXECUTED IN ACCORDANCE WITH THE SPECIFICATIONS OF THE RESPECTIVE AGENCY AT NO ADDITIONAL EXPENSE TO THE OWNER INCLUDING ANY INSPECTION FEES OR MAINTENANCE CREWS. UTILITY RELOCATION AND SUPPORT COST SHALL BE INCLUDED IN OTHER BID ITEMS.
- WHERE EXISTING POWER OR TELEPHONE POLES ARE IN CLOSE PROXIMITY TO WORK, THE CONTRACTOR SHALL COORDINATE HIS WORK EFFORTS WITH THOSE OF THE UTILITY COMPANIES SUCH THAT THEIR EXISTING FACILITIES CAN BE MAINTAINED AND PROTECTED DURING THE TIME WORK IS GOING ON ADJACENT TO THE POLE. THE COST FOR ANY REQUIRED PROTECTION OR RELOCATION OF EXISTING POWER OR TELEPHONE POLES SHALL BE THE RESPONSIBILITY OF THE CONTRACTOR AND NOT BE THE RESPONSIBILITY OF THE OWNER.
- THE UTILITY OWNERSHIPS, AS REPORTED BY OUPS, ARE AS LISTED ON THE COVER SHEET OF THIS PROJECT'S PLAN SET AND THE CONTACT INFORMATION FOR EACH UTILITY IS LISTED BELOW.

AQUA AMERICA  
KENNETH DAY  
6650 SOUTH AVENUE  
BOARDMAN, OHIO 44512  
330-397-0787

CHARTER  
GARY NAUMANN  
8179 DOW CIRCLE  
STRONGSVILLE, OHIO 44136  
216-575-8016

CENTURYLINK  
PAT FARONE  
1 FEDERAL PLAZA WEST, STE 1000  
YOUNGSTOWN, OHIO 44503  
724-312-7908

DOMINION EAST OHIO  
BILL SNYDER  
320 SPRINGSIDE DR. SUITE 320  
AKRON, OHIO 44333  
330-926-4700

AT&T  
HAROLD MAYNARD  
50 WEST BOWERY STREET  
AKRON, OHIO 44308  
330-384-8974

OHIO EDISON  
RAYMOND JENKINS, JR.  
730 SOUTH AVENUE  
YOUNGSTOWN, OHIO 44502  
330-740-7625

## MATERIAL DISPOSAL AND TEMPORARY SURFACES:

- THE REMOVAL AND DISPOSAL OF ALL SURPLUS EXCAVATED MATERIAL AND CONSTRUCTION DEBRIS SHALL BE THE RESPONSIBILITY OF THE CONTRACTOR FOR ULTIMATE DISPOSAL. THE CONTRACTOR SHALL OBTAIN ALL APPROVALS, PERMITS, LICENSES, ETC. FROM LOCAL, STATE AND FEDERAL AGENCIES AND/OR PRIVATE LANDOWNERS. THE CONTRACTOR SHALL FURNISH THE ENGINEER A COPY OF ALL APPROVALS OR WRITTEN PERMISSION PRIOR TO DISPOSING OF ANY WASTE AT SAID SITE.
- THE CONTRACTOR SHALL BE RESPONSIBLE FOR THE COMPLETE RESTORATION OF ALL MATERIAL WASTE AREAS USED IN THE COURSE OF THIS CONTRACT. THE RESTORATION WORK SHALL INCLUDE CLEANUP, SHAPING AND GRADING AND ESTABLISHMENT OF VEGETATIVE COVER BY SEEDING AND MULCHING IN ACCORDANCE WITH ODOT SPECIFICATION NO. 659. THE FINAL GRADING OF WASTE AREAS SHALL BE PROPERLY SLOPED TO PROVIDE DRAINAGE RUNOFF. ALL ROCKS, BOULDERS AND CONCRETE CHUNKS SHALL BE BURIED WITHIN THE WASTE AREA TO A DEPTH OF AT LEAST TWO (2) FEET AND SHALL NOT BE VISIBLE AT COMPLETION.
- THE COST OF HEREIN DESCRIBED WORK, INCLUDING SEEDING AND MULCHING NECESSARY TO SECURE THESE RESULTS, SHALL BE CONSIDERED INCIDENTAL TO THE OTHER VARIOUS ITEMS OF WORK IN THIS CONTRACT AND INCLUDED IN THE RESPECTIVE PAY ITEMS. NO SEPARATE PAYMENT SHALL BE MADE.
- TEMPORARY SURFACES WHERE EXCAVATION ARE LOCATED IN STREETS, DRIVES AND PARKING AREAS SHALL BE FURNISHED AND PLACED BY THE CONTRACTOR AND SHALL BE FULLY MAINTAINED TO MINIMIZE INCONVENIENCE TO THE PUBLIC AT NO ADDITIONAL COST TO THE OWNER.
- THE ABOVE DESCRIBED WORK SHALL BE CONSIDERED INCIDENTAL TO THE COMPLETION OF ALL WORK AND INCLUDED IN THE RESPECTIVE PAY ITEMS AND SHALL NOT BE A SEPARATE PAY ITEM.
- DUMP SITES MUST BE APPROVED BY THE OWNER.

## CLEARING AND GRUBBING:

- ALL STUMPS, TREES, UNSUITABLE EXCAVATED MATERIAL, AND OTHER CONSTRUCTION DEBRIS SHALL BE DISPOSED OF BY THE CONTRACTOR, AND INCLUDED IN THE BID PRICE.
- NO BACKFILLING OF ANY TRENCHES OR EXCAVATIONS WILL BE PERMITTED WITHOUT TAMPING EQUIPMENT BEING USED. FLOODING, JETTING OR PUDDLING OF BACKFILL WILL NOT BE PERMITTED.
- ALL EXCAVATION SHALL BE CONSIDERED UNCLASSIFIED. NO ADDITIONAL COMPENSATION SHALL BE PAID TO THE CONTRACTOR FOR ROCK OR SHALE EXCAVATION.
- THE CONTRACTOR SHALL INCLUDE ALL NECESSARY PRECAUTIONS TO PROTECT AND SAVE ALL TREES WHICH ARE ADJACENT TO THE LINE OF WORK AND SHALL REMOVE ONLY THOSE TREES WHICH ARE DESIGNATED FOR REMOVAL ON THE PLANS OR DIRECTED BY THE ENGINEER. TREE ROOTS AND OVERHANGING BRANCHES SHALL BE CUT AND REMOVED FROM THE SITE, EXCEPT WITH SPECIAL PERMISSION OF THE ENGINEER. REFER TO PLANS FOR LOCATIONS OF TREE REMOVAL AND CLEARING AND GRUBBING.

## RESTORATION:

- CONTRACTOR SHALL RESTORE ANY DISTURBED AREAS CAUSED FROM CONSTRUCTION TO PRE-CONSTRUCTION CONDITIONS OR BETTER. FOR DISTURBED LAWN AREAS, THE CONTRACTOR SHALL INSTALL COMPACTED, SCREENED, IMPORTED TOPSOIL TO PROVIDE A SMOOTH TRANSITION FROM THE TOP BACK OF NEW CURB SURFACES TO THE EXISTING NON-PAVED SURFACE OR EXISTING SIDEWALK.
- ALL GRASS AREAS ARE TO BE RESTORED UNLESS OTHERWISE SHOWN ON THE CONTRACT DRAWINGS.
- ALL DISTURBED PROPERTY SHALL BE RESTORED TO THE PRE-CONSTRUCTION CONDITION OR BETTER WITHIN 30 DAYS OF DISTURBANCE.
- THE COMPOSITION OF SEED MIXTURE SHALL CONFORM TO THE PROJECT SPECIFICATIONS FOR SEEDING.
- ALL EXISTING CASTINGS, VALVE COVERS, PULL BOXES, AND ALL OTHER UTILITY APPURTENANCES SHALL BE ADJUSTED TO BE FLUSH WITH THE FINISHED GRADE PRIOR TO FINAL RESURFACING.

## NOISE CONTROL PRACTICES:

- CONSTRUCTION ACTIVITIES WILL BE LIMITED TO WEEKDAY DAYTIME HOURS, UNLESS APPROVED IN ADVANCE BY THE OWNER.
- CONSTRUCTION EQUIPMENT WILL BE PROVIDED WITH INTAKE SILENCERS AND MUFFLERS, AS REQUIRED BY SAFETY STANDARDS.
- ALL CONSTRUCTION VEHICLES SHOULD BE EQUIPPED WITH PROPER EMISSIONS CONTROL EQUIPMENT.
- PERIODICALLY CHECK EQUIPMENT AND MACHINERY FOR PROPER TUNING TO MINIMIZE EXHAUST EMISSIONS AND NOISE.

## PROHIBITED CONSTRUCTION ACTIVITIES:

- THE USE OF EXPLOSIVES WITHIN VILLAGE LIMITS, UNLESS A PERMIT IS ISSUED BY THE OWNER.
- PUMPING OF SEDIMENT-LADEN WATER FROM TRENCHES OR OTHER EXCAVATIONS DIRECTLY INTO ANY SURFACE WATERS, STREAM CORRIDORS, OR STORM SEWERS; ALL SUCH WATER WILL BE PROPERLY FILTERED OR SETTLED TO REMOVE SILT PRIOR TO RELEASE.
- DISCHARGING POLLUTANTS SUCH AS CHEMICALS, FUELS, LUBRICANTS, BITUMINOUS MATERIALS, RAW SEWAGE, OR ANY OTHER HARMFUL WASTE INTO OR ALONGSIDE OF RIVERS, STREAMS, IMPOUNDMENTS OR INTO NATURAL OR MAN-MADE CHANNELS LEADING THERETO.
- OPEN BURNING OF PROJECT DEBRIS WITHOUT A PERMIT.
- STORING CONSTRUCTION EQUIPMENT AND VEHICLES AND/OR STOCKPILING CONSTRUCTION MATERIALS ON PROPERTY, PUBLIC OR PRIVATE, NOT PREVIOUSLY SPECIFIED ON THE PLANS BY THE ENGINEER FOR SUCH PURPOSES.
- RUNNING WELL POINT OR PUMP DISCHARGE LINES THROUGH PRIVATE OR PUBLIC PROPERTY AND RIGHTS-OF-WAY WITHOUT PERMISSION OF THE PROPERTY OWNER AND THE CONSENT OF THE ENGINEER.
- OPERATION ENTAILING THE USE OF VIBRATORY HAMMERS OR COMPACTORS OUTSIDE THE HOURS OF 8:00 AM AND 5:00 PM OR OUTSIDE THE HOURS ALLOWED BY LOCAL ORDINANCES OR REGULATIONS.
- CLOSING OFF CLEAR ACCESS TO ANY PUBLIC ALLEY, STREET, ROAD, AVENUE OR BOULEVARD WITHOUT THE PRIOR CONSENT OF MUNICIPAL OFFICIALS AND THE ENGINEER AND CLOSING CLEAR ACCESS:
  - BY FIRE PROTECTION EQUIPMENT AND EMERGENCY VEHICLES;
  - BY THE PUBLIC TO ANY COMMERCIAL OR PROFESSIONAL PLACE OF BUSINESS, QUASI-PUBLIC OR PUBLIC ESTABLISHMENT, OR PLACE OF RESIDENCE; OR
  - BY VEHICLES TO DRIVEWAYS WITHOUT THE PROVISION OF ALTERNATIVE MEANS OF BUILDING INGRESS AND EGRESS.

## PROPOSED IMPROVEMENTS:

- THE USE OF SLAG OR RECYCLED PRODUCTS WILL NOT BE PERMITTED FOR USE FOR ANY ASPECT OF THIS PROJECT UNLESS APPROVED BY THE MUNICIPALITY AND THE ENGINEER. SPECIFICALLY, NO RECYCLED ASPHALT PRODUCT (RAP) WILL BE PERMITTED.
- THE COARSE AGGREGATE MATERIAL SHALL BE ONLY LIMESTONE FOR ALL ASPHALT CONCRETE AND ASPHALT CONCRETE SURFACE COURSE.
- THE EXPANSION JOINT MATERIAL SHALL BE W.R. MEADOWS SPONGE RUBBER EXPANSION JOINT MATERIAL, COLOR GRAY, OR APPROVED SUBSTITUTE.
- ADDITIONAL GENERAL SITE IMPROVEMENTS NOTES PERTAINING TO THE ENTIRETY OF THE PROJECT CAN BE FOUND ON SHEET 08 - SITE IMPROVEMENTS - 01.
- THIS PROJECT UTILIZES STATIONS AND OFFSETS WITH REFERENCE TO ROADWAY CENTERLINE ALIGNMENTS IN ORDER TO APPROXIMATELY ILLUSTRATE WHERE IMPROVEMENTS BEGIN AND END.
- ALL STATIONS AND OFFSETS ARE APPROXIMATE. IMPROVEMENTS INVOLVING TYING NEW IMPROVEMENTS INTO EXISTING CONSTRUCTION SHALL BE PERFORMED AND INSTALLED TO THE NEAREST CONSTRUCTION JOINTS AND TIE-IN TO THE EXISTING CONSTRUCTION AT THE SAME ELEVATION OR IN A SIMILAR MANNER TO EXISTING.
- ALL PAVEMENT PAINTING SHALL CONFORM TO THE MOST CURRENT ODOT STANDARDS AND SPECIFICATIONS AND OCCUR AFTER FINAL PAVEMENT RESURFACING. TRAFFIC PAINT SHALL BE OF TYPE ODOT 643 - POLYESTER PAVEMENT MARKING.
- THE LIMITS OF PROPOSED ASPHALT RESURFACING SHALL EXTEND TO THE NEAREST EXISTING PAVEMENT JOINT OR TO THE LIMITS SHOWN IN THE PLANS IF NO JOINT EXISTS WITHIN 10-FEET OF THE ILLUSTRATED LIMITS.
- RUBBERIZED ASPHALT SEALER SHALL BE INSTALLED AFTER FINAL RESURFACING, AT A MINIMUM, AT THE FOLLOWING LOCATIONS:
  - INTERFACE OF NEW AND EXISTING ASPHALT
  - INTERFACE OF NEW ASPHALT AND NEW OR EXISTING CURBING
  - INTERFACE OF NEW ASPHALT AND EXISTING CASTINGS
  - COLD JOINTS OF NEW ASPHALT (24-HOURS OR MORE BETWEEN PLACEMENT OF ADJACENT ASPHALT)
- ALL ASPHALT GRINDINGS WILL BE PROVIDED AND DELIVERED TO THE OWNER AT NO ADDITIONAL COST. THE OWNER SHALL BE NOTIFIED BY THE CONTRACTOR AT LEAST 48-HOURS PRIOR TO STOCKPILING THE GRINDINGS IN ORDER TO DETERMINE THE SPECIFIC STOCKPILE LOCATION. THE GRINDINGS WILL BE STOCKPILED IN A LOCATION SPECIFIED BY THE OWNER AT THE VILLAGE OF LOWELLVILLE STREET DEPARTMENT GARAGE ON MCGAFFNEY STREET. NO STOCKPILING SHALL TAKE PLACE UNTIL THE OWNER IS NOTIFIED AND THE STOCKPILE LOCATION HAS BEEN DETERMINED BY THE OWNER.
- ANY EXISTING DRIVEWAY APRON THAT IS DAMAGED OR AFFECTED BY CONSTRUCTION, UNLESS SPECIFIED TO BE REPLACED IN THE PLANS, SHALL BE REPLACED IN-KIND AT NO ADDITIONAL COST TO THE OWNER OR THE PROJECT. NO ADDITIONAL PAYMENT FOR TIME OR MATERIALS WILL BE MADE.
- EXISTING SIDEWALK BEING REPLACED SHALL BE INSTALLED AT THE SAME ELEVATION AS EXISTING. THE NEW SIDEWALK SHALL TIE-IN FLUSH TO EXISTING SURROUNDING FEATURES SUCH AS EXISTING DRIVEWAYS, SIDEWALK, LAWN AREAS, ETC. IF THE NEW SIDEWALK IS DEEMED BY THE ENGINEER OR THE OWNER TO NOT CONFORM TO THE EXISTING FEATURES, THE CONTRACTOR WILL REPLACE THE NEW SIDEWALK AT NO ADDITIONAL COST TO THE OWNER OR THE PROJECT. NO ADDITIONAL PAYMENT FOR TIME OR MATERIALS WILL BE MADE.
- EXISTING SANDSTONE CURB BEING REMOVED SHALL BE NEATLY SAWCUT AND REMOVED CAREFULLY SO AS TO PREVENT DAMAGE OR BROKEN SECTIONS, WHEN POSSIBLE. THE OWNER WILL DETERMINE IN THE FIELD WHICH, IF ANY, SECTIONS SHALL BE STOCKPILED AT THE VILLAGE OF LOWELLVILLE STREET DEPARTMENT AT NO ADDITIONAL COST. THE CONTRACTOR SHALL NOTIFY THE OWNER AT LEAST 48-HOURS PRIOR TO WORK INVOLVING REMOVING THE EXISTING CURB.
- ADA DETECTABLE WARNING PAD SHALL BE DURALAST DETECTABLE WARNING PLATE, EJIW PRODUCT NUMBER 00700571, OR APPROVED SUBSTITUTE.
- EXISTING PAVEMENT/DRIVEWAYS BEHIND LOCATIONS OF NEW CONCRETE DRIVEWAY APRONS SHALL BE NEATLY SAWCUT AT THE APPROXIMATE LIMITS SHOWN IN THE PLANS. THE CONTRACTOR SHALL FORM UP TO THE EXISTING DRIVEWAY APRON AND INSTALL EXPANSION JOINT MATERIAL AT THE INTERFACE OF EXISTING TO NEW PAVEMENT. IN NO CASE SHALL A GAP EXIST BETWEEN THE NEW AND EXISTING PAVEMENT/DRIVEWAY.

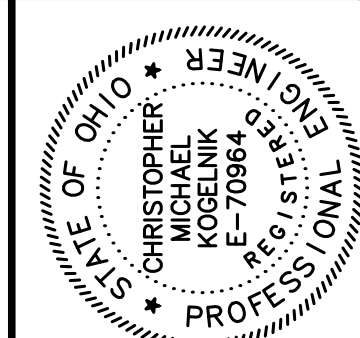

your trusted advisor  
engineers  
architects  
planners



DATE	REVISION	NO	BID SET	ISSUED FOR:	ISSUE DATE:	SCALE:	DESIGNED BY:	DRAWN BY:	CHECKED BY:
			07/19/2019	AS SHOWN	EMS	EMS	CHIK		

VILLAGE OF LOWELLVILLE  
WEST WOOD STREET  
IMPROVEMENTS PROJECT  
LOWELLVILLE MAHONING COUNTY OHIO  
GENERAL NOTES - 01

PROJECT NO.	190074
DISCIPLINE	GENERAL
SHEET NAME	GN-01
SHEET	OF
02	11



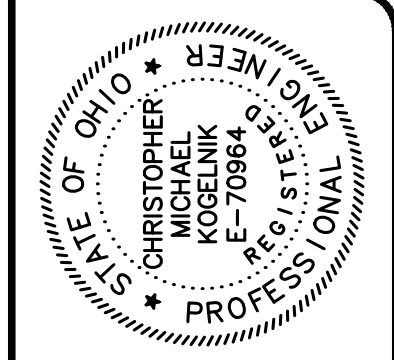

NO	REVISION	DATE

ISSUED FOR:	BID SET	07/19/2019
ISSUE DATE:	AS SHOWN	EMS
SCALE:	DESIGNED BY:	EMS
DRAWN BY:	CHECKED BY:	CMK

**VILLAGE OF LOWELLVILLE**  
**WEST WOOD STREET**  
**IMPROVEMENTS PROJECT**  
 LOWELLVILLE MAHONING COUNTY OHIO  
**CONSTRUCTION DETAILS - 01**

PROJECT NO.	190074
DISCIPLINE	GENERAL
SHEET NAME	CD-01
SHEET	OF
04	11

**NOTES:**

- TIE-IN NEW CURBING TO EXISTING DRIVEWAY DEPRESSED CURB BY NEATLY SAWCUTTING AND REMOVING THE EXISTING CURB AS ILLUSTRATED, UNLESS OTHERWISE NOTED IN THE PLANS.
- IF DRIVEWAY IS DAMAGED OR AFFECTED BY CONSTRUCTION, THE CONTRACTOR SHALL REPLACE THE DRIVEWAY APRON FOR THE ENTIRE WIDTH UP TO THE NEAREST CONSTRUCTION JOINT BY NEATLY SAWCUTTING AT THE JOINT AND FORMING UP TO THE EXISTING APRON WITH EXPANSION JOINT MATERIAL INSTALLED AT INTERFACES BETWEEN EXISTING AND NEW MATERIAL.
- EXISTING SUBBASE MATERIAL (IF ANY) SHALL BE REPLACED, AS DIRECTED BY ENGINEER OR VILLAGE OFFICIALS.
- USE EXPANSION JOINTS AS PER TYPICAL CONSTRUCTION JOINTS DETAIL.
- NEW DRIVEWAYS SHALL BE DOWELED INTO EXISTING CONCRETE DRIVEWAYS AS PER SIDEWALK CONNECTION DETAIL, WHERE APPLICABLE.

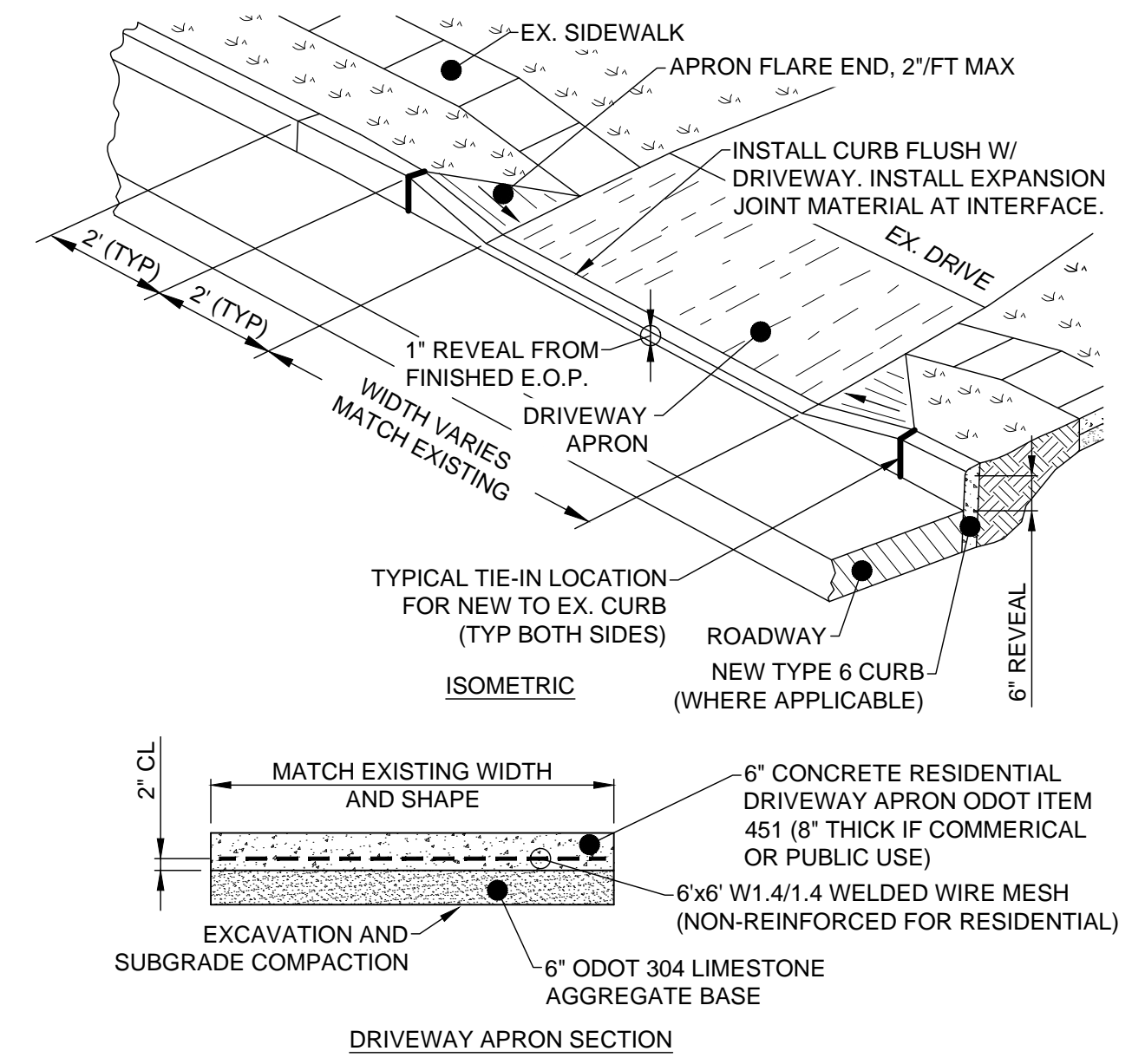

**DEPRESSED CURB & DRIVEWAY APRON DETAIL**  
NOT TO SCALE

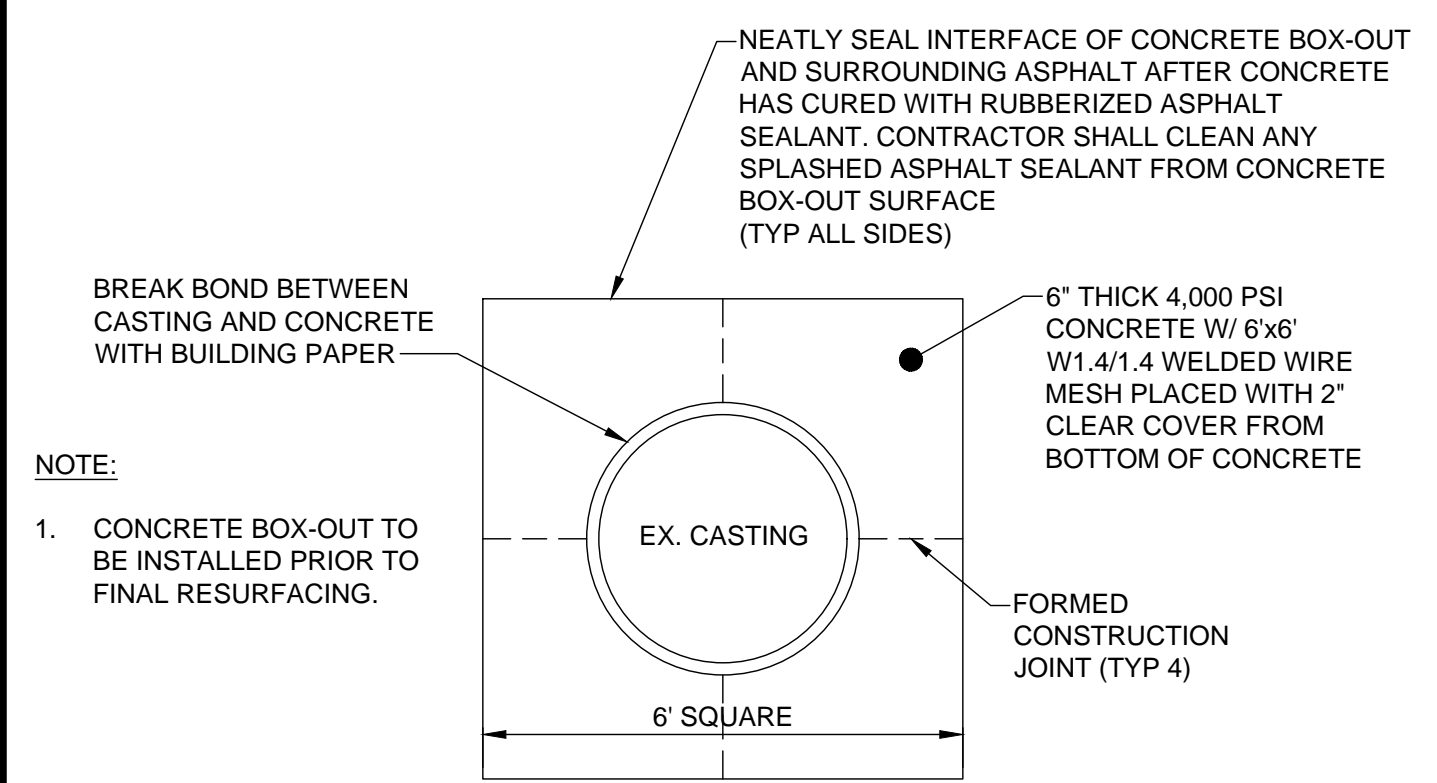

**CONCRETE BOX-OUT DETAIL**  
NOT TO SCALE

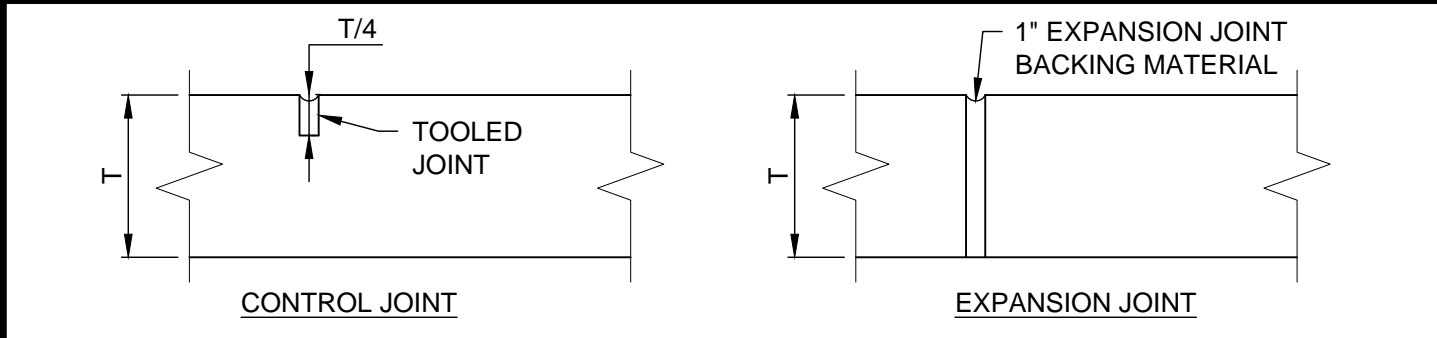

- CONTROL JOINT NOTES:**
- CONTROL JOINTS SHALL BE TOOLED, SAWCUTTING NEW CONCRETE IS NOT PERMITTED.
  - CONTROL JOINT SPACING SHALL EQUAL NEW SIDEWALK WIDTH, ADD ADDITIONAL DIAGONAL JOINTS AS NECESSARY TO CONTROL CRACKING AT ANGLES, BUILDINGS OR STRUCTURES.
- EXPANSION JOINT NOTES:**
- EXPANSION JOINTS WITH EXPANSION JOINT MATERIAL SHALL BE INSTALLED AT INTERFACES OF DIFFERENT POURS.
  - EXPANSION JOINTS ARE TO BE INSTALLED ON ALL JOINTS BETWEEN NEW CONCRETE SECTIONS AND: EXISTING SIDEWALK SECTIONS, EXISTING CONCRETE PAVEMENT, NEW OR EXISTING CURBING OR APRONS, AND ANY OTHER STRUCTURAL FEATURES (I.E. UTILITY KNOCKOUTS, BUILDINGS, ETC.).

**TYPICAL CONSTRUCTION JOINTS**  
NOT TO SCALE

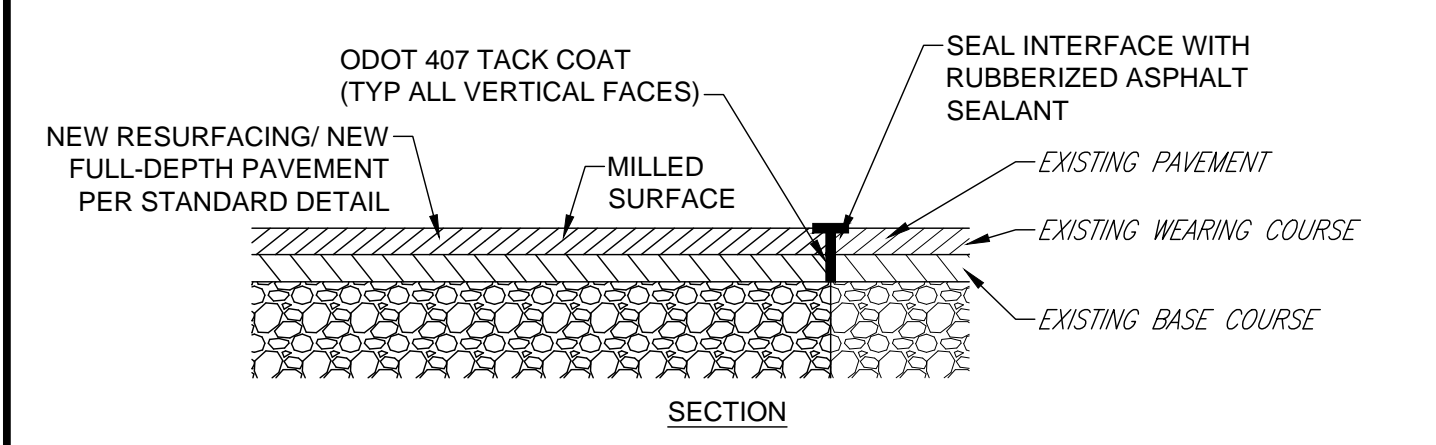

- NOTE:**
- BUTT JOINTS SHALL BE A NEAT, STRAIGHT LINE AT THE TERMINATION POINT OF ALL MILLING OPERATIONS.

**BUTT JOINT DETAIL**  
NOT TO SCALE

**NOTES:**

- ALL EXISTING LAWN AREAS DISTURBED SHALL BE RESTORED TO MATCH THE EXISTING CONDITIONS BY FILLING ANY DISTURBED AREAS WITH SCREENED, IMPORTED TOPSOIL TO BE FLUSH WITH THE EXISTING AND/OR PROPOSED CURB AND SIDEWALK. ALL DISTURBED AREAS SHALL BE SEEDED AND MULCHED IN ACCORDANCE WITH THE SPECIFICATIONS.
- LAWN AREAS BETWEEN NEW OR EXISTING SIDEWALK BEHIND NEW CURB SHALL BE QUANTIFIED AND INCLUDED WITHIN THE BID ITEM COST FOR THE NEW CURB. ALL OTHER LAWN AREA RESTORATION AND LAWN AREAS BEHIND NEW SIDEWALK SHALL BE INCLUDED IN THE BID ITEM COST FOR SEEDING AND MULCHING.
- THE CONTRACTOR SHALL INSTALL EXPANSION JOINT FILLER BETWEEN EXISTING SIDEWALK TO REMAIN IN PLACE AND NEW SIDEWALK INSTALLED AS PART OF THE PROJECT (PER ODOT 608.03). EXPANSION JOINT MATERIAL SHALL BE INSTALLED BETWEEN EXISTING RIGID DRIVEWAYS AND NEW SIDEWALK.
- NEW CONCRETE WALK SHALL TIE-IN AND MATCH THE EXISTING ELEVATION OF EXISTING SIDEWALK, CURB RAMPS, DRIVEWAYS AND DRIVE APRONS, ETC. NEWLY INSTALLED WALK NOT PROPERLY MATCHING ELEVATIONS AS DEEMED BY THE ENGINEER OR OWNER SHALL BE REMOVED AND REPLACED AT THE CONTRACTOR'S EXPENSE. NO ADDITIONAL PAYMENT WILL BE MADE FOR TIME OR MATERIAL.
- SURFACE OF SUBBASE TO BE UNIFORM AND FREE OF ANY UNDULATIONS OR FOREIGN MATERIAL PRIOR TO INSTALLATION OF 4" CONCRETE SIDEWALK.
- CONTRACTOR TO MAINTAIN POSITIVE DRAINAGE TO PREVENT PONDING WITHIN RIGHT-OF-WAY OR PRIVATE PROPERTY.

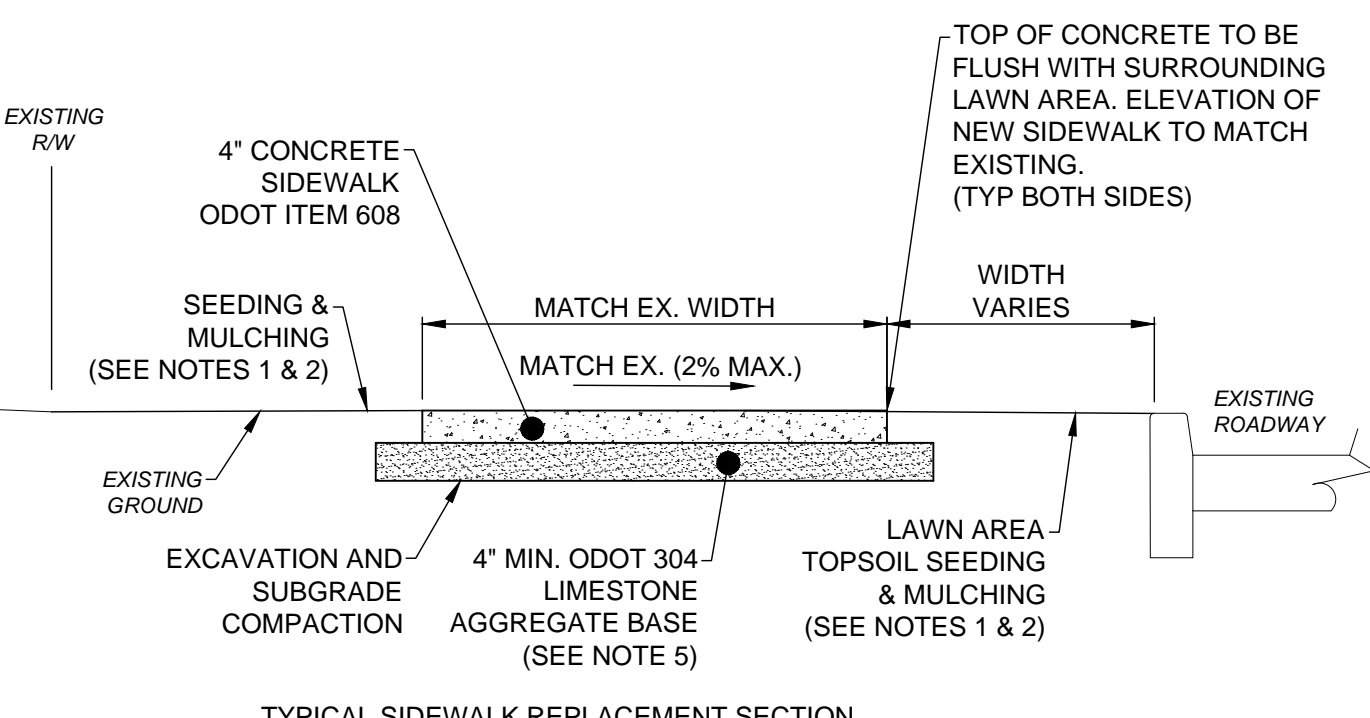

**SIDEWALK REPLACEMENT DETAIL**  
NOT TO SCALE

**NOTES:**

- EXISTING UNSUITABLE SUBBASE MATERIAL (IF ANY) SHALL BE REPLACED, AS DIRECTED BY ENGINEER OR VILLAGE OFFICIALS.
- CONTRACTOR TO MAINTAIN EX. ROAD CROSS-SLOPE AND ELEVATION OF EDGE OF PAVEMENT.
- GROUT MAY BE SUBSTITUTED WITH SAME CONCRETE AS CURB MIX, AS APPROVED BY THE ENGINEER.
- SURFACE COURSE AND OTHER SURFACE IMPROVEMENT ITEMS SHALL BE INSTALLED WHEN PROJECT'S FINAL RESURFACING IS PERFORMED.

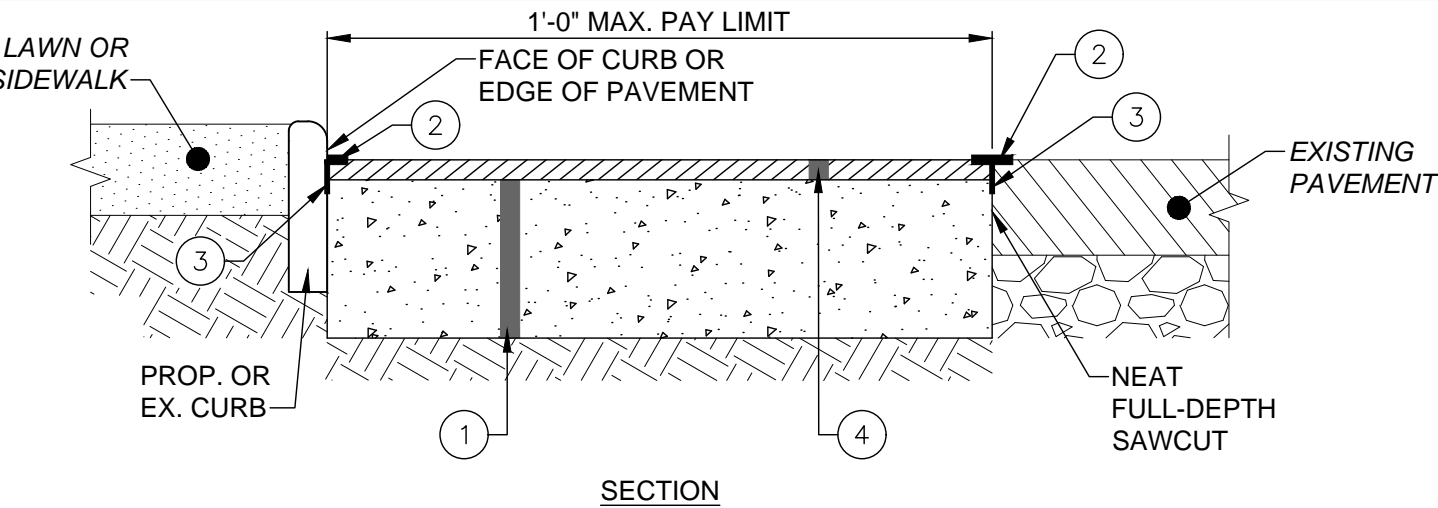

- CODED NOTES:**
- INSTALL 12" OF 8 SACK CONCRETE GROUT BETWEEN NEW CURB AND EXISTING PAVEMENT (SEE NOTE 3)
  - BITUMINOUS SEALER ODOT ITEM 702.01, 702.02 OR 702.04. (SEE NOTE 3)
  - ODOT 407 TACK COAT (TYP. ALL EXPOSED VERTICAL SURFACES)
  - 2" MIN. ODOT 448 - ASPHALT CONCRETE SURFACE COURSE, TYPE 1, PG64-22, AS PER PLAN (SEE NOTE 4)

**FULL-DEPTH ROAD REPLACEMENT DETAIL**  
NOT TO SCALE



**CONTROL MAP**  
STATE OF OHIO, COUNTY OF MAHONING, VILLAGE OF LOWELLVILLE

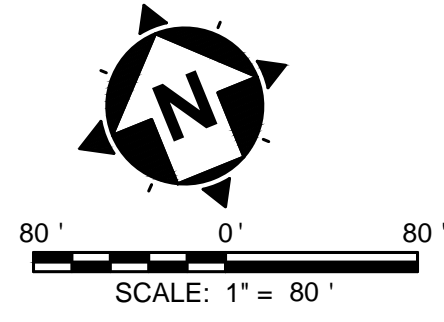

VICINITY MAP  
1"=800'



**NOTES:**

- 1) HORIZONTAL DATUM IS NAD83 (2011 ADJ.), VERTICAL DATUM NAVD88 (GEOID 12B)
- 2) ALL COORDINATE VALUES ARE GRID VALUES
- 4) ALL CONTROL POINTS ARE 5/8" REBAR WITH RED CAPS INSCRIBED WITH "CT REFERENCE"
- 5) PARCEL LINES SHOWN HEREON ARE DERIVED FROM A GIS DATABASE AND DO NOT REPRESENT ACTUAL BOUNDARY LIMITS.

CONTROL TABLE				
POINT #	NORTHING	EASTING	ELEVATION	DESCRIPTION
1	508073.19	2505958.49	850.84	SCIPIS
2	507929.98	2506375.60	851.94	SCIPIS
3	507862.61	2506606.73	851.85	SCIPIS
4	507589.97	2507098.54	855.64	SCIPIS
5	507492.52	2507409.28	852.88	SCIPIS
6	507323.84	2507804.24	857.32	SCIPIS

**BENCHMARKS:**

**BM#1**  
BEING A CHISELED "X" ON A NORTHERLY BOLT OF A HYDRANT, SAID HYDRANT LOCATED ON THE NORTHERLY SIDE OF W WOOD STREET, BEING APPROXIMATELY 200 FEET EASTERLY FROM THE INTERSECTION OF SAID W WOOD STREET AND DICKSON STREET. ELEV.=852.15'

**BM#2**  
BEING A CHISELED "X" ON A NORTHERLY BOLT OF A HYDRANT, SAID HYDRANT LOCATED ON THE NORTHERLY SIDE OF W WOOD STREET, BEING APPROXIMATELY 52 FEET WESTERLY FROM THE INTERSECTION OF SAID W WOOD STREET AND NORTH AVENUE. ELEV.=853.08'

**BM#3**  
BEING A CHISELED "X" ON A NORTHERLY BOLT OF A HYDRANT, SAID HYDRANT LOCATED ON THE NORTHERLY SIDE OF W WOOD STREET, BEING APPROXIMATELY 25 FEET EASTERLY FROM THE INTERSECTION OF SAID W WOOD STREET AND ELIZABETH STREET. ELEV.=858.90'

**BM#4**  
BEING A CHISELED "X" ON THE NORTHERLY ARROW BOLT OF A HYDRANT, SAID HYDRANT LOCATED ON THE SOUTHERLY SIDE OF W WOOD STREET, BEING APPROXIMATELY 25 FEET SOUTHWESTERLY FROM THE INTERSECTION OF SAID W WOOD STREET AND YOUNGSTOWN-LOWELLVILLE ROAD, AND 4 FEET SOUTHERLY FROM POWER POLE #72B-27, LOCATED AT THE SOUTHWESTERLY CORNER OF SAID INTERSECTION. ELEV.=856.16'

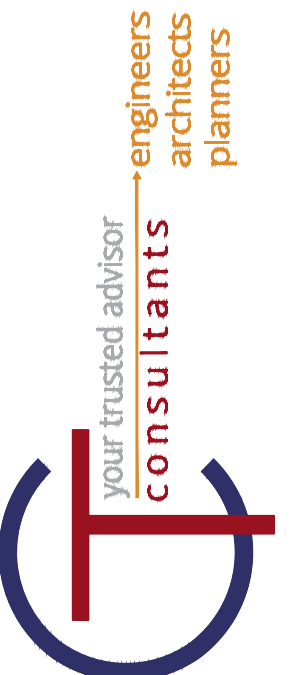
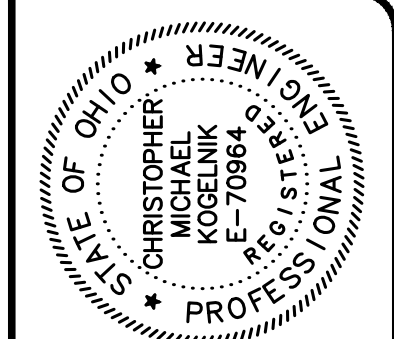

DATE	REVISION	NO	BID SET	ISSUED FOR:	ISSUE DATE:	SCALE:	DESIGNED BY:	DRAWN BY:	CHECKED BY:
			07/19/2019	AS SHOWN	AS SHOWN	EMS	EMS	EMS	CMK

**VILLAGE OF LOWELLVILLE**  
**WEST WOOD STREET**  
**IMPROVEMENTS PROJECT**  
LOWELLVILLE  
MAHONING COUNTY  
OHIO

**SURVEY CONTROL PLAN**

PROJECT NO.	<b>190074</b>
DISCIPLINE	<b>CIVIL</b>
SHEET NAME	<b>SVC</b>
SHEET	<b>06</b>
OF	<b>11</b>

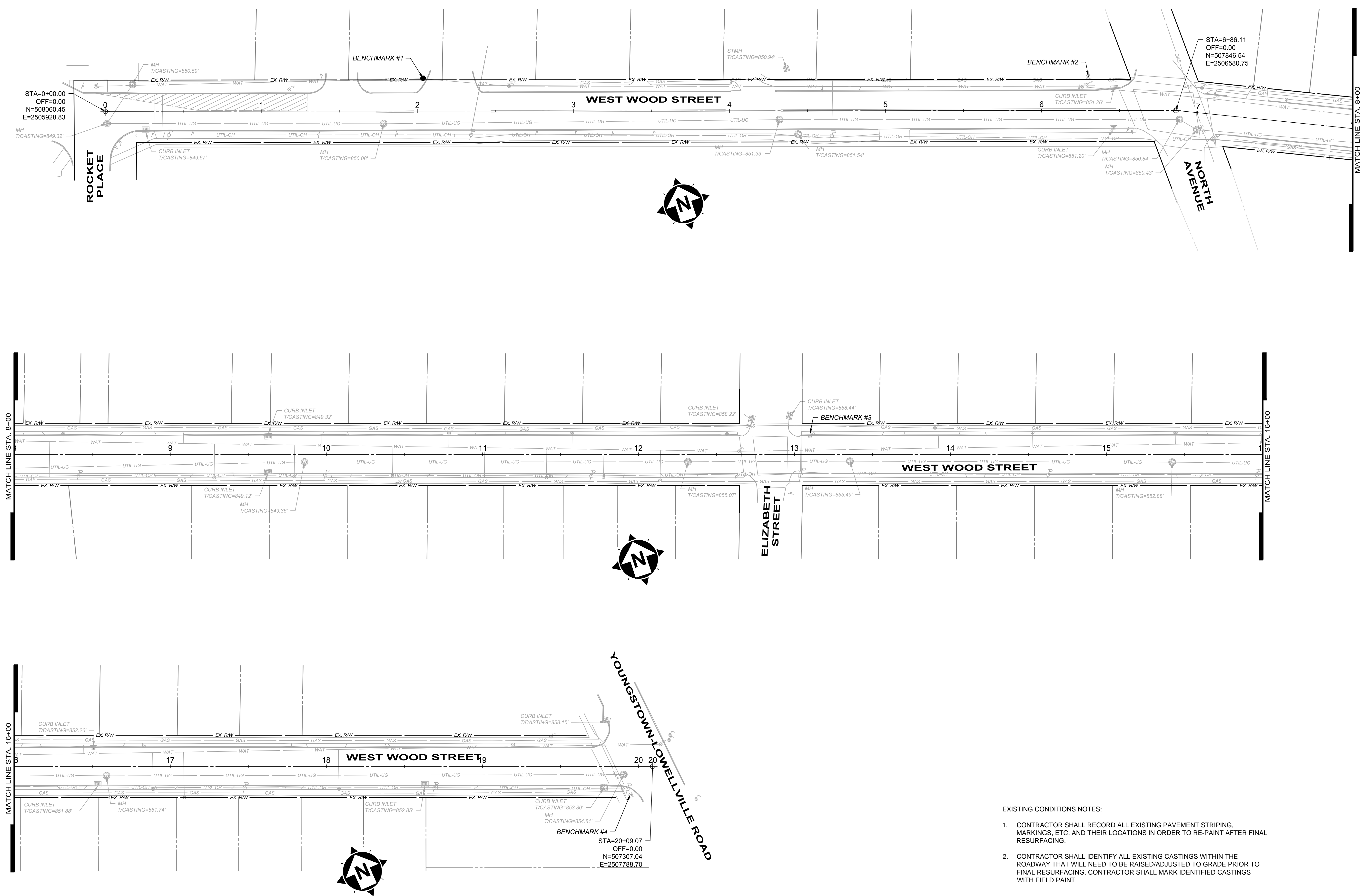

- EXISTING CONDITIONS NOTES:**
- CONTRACTOR SHALL RECORD ALL EXISTING PAVEMENT STRIPING, MARKINGS, ETC. AND THEIR LOCATIONS IN ORDER TO RE-PAINT AFTER FINAL RESURFACING.
  - CONTRACTOR SHALL IDENTIFY ALL EXISTING CASTINGS WITHIN THE ROADWAY THAT WILL NEED TO BE RAISED/ADJUSTED TO GRADE PRIOR TO FINAL RESURFACING. CONTRACTOR SHALL MARK IDENTIFIED CASTINGS WITH FIELD PAINT.

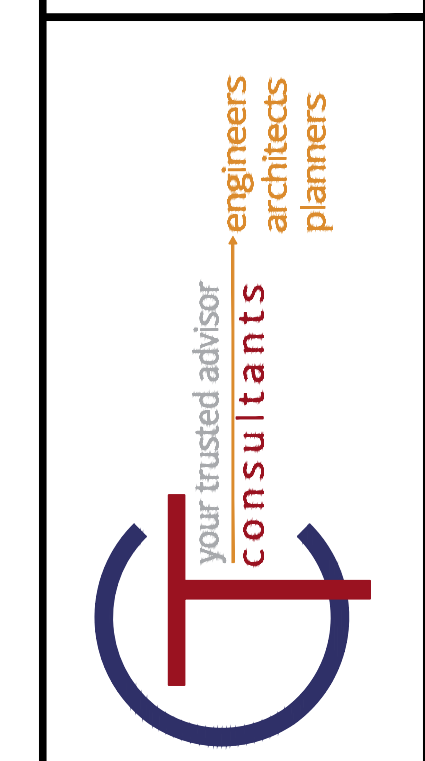
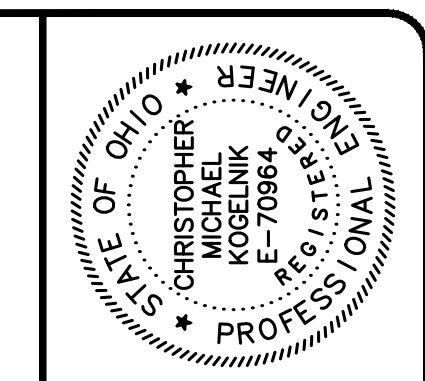
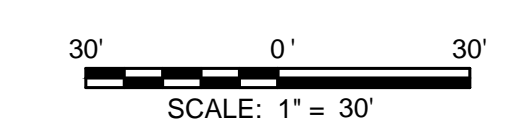

NO.	REVISION	DATE

ISSUED FOR:	BID SET	NO.	
ISSUE DATE:	07/19/2019		
SCALE:	AS SHOWN		
DESIGNED BY:	EMS		
DRAWN BY:	EMS		
CHECKED BY:	CMK		

**VILLAGE OF LOWELLVILLE**  
**WEST WOOD STREET**  
**IMPROVEMENTS PROJECT**  
 LOWELLVILLE  
 MAHONING COUNTY  
 OHIO

**EXISTING CONDITIONS**

PROJECT NO.	190074
DISCIPLINE	CIVIL
SHEET NAME	EC-01
SHEET	07
OF	11





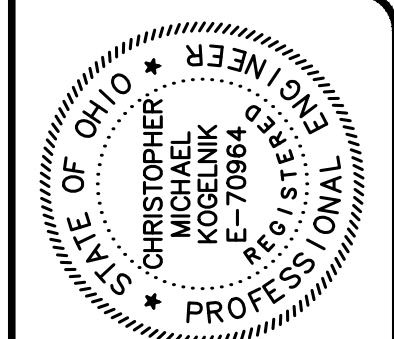

NO	REVISION	DATE

**VILLAGE OF LOWELLVILLE**  
**WEST WOOD STREET**  
**IMPROVEMENTS PROJECT**  
 LOWELLVILLE MAHONING COUNTY OHIO

**SITE IMPROVEMENTS - 02**

PROJECT NO.	190074
DISCIPLINE	CIVIL
SHEET NAME	SI-02
SHEET	09
OF	11

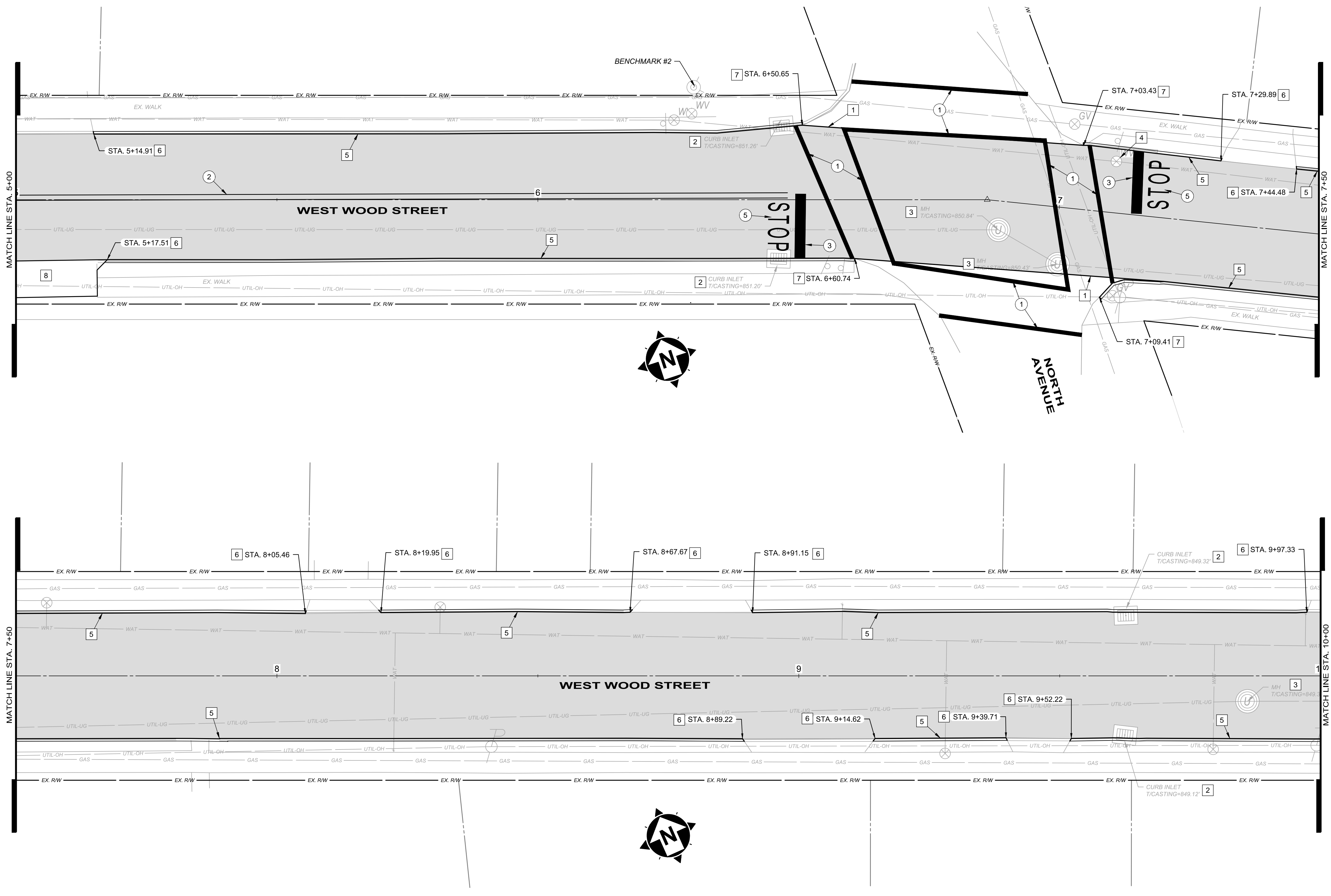

- PAVEMENT MARKING CODED NOTES:**
- ① CROSSWALK LINE, 12-INCH WIDE, WHITE, ODOT 643
  - ② CENTER LINE, 4-INCH WIDE, YELLOW, ODOT 643
  - ③ STOP LINE, 24-INCH WIDE, WHITE, ODOT 643
  - ④ DIAGONAL LINE, 12-INCH WIDE, YELLOW, ODOT 643
  - ⑤ WORD ON PAVEMENT, 'STOP', WHITE, ODOT 643

- SITE IMPROVEMENTS CODED NOTES:**
- ① LIMITS OF ROADWAY RESURFACING
  - ② INLET ADJUSTED TO GRADE, ODOT 611, AS PER PLAN
  - ③ MANHOLE ADJUSTED TO GRADE, ODOT 611, AS PER PLAN
  - ④ VALVE BOX ADJUSTED TO GRADE, ODOT 638, AS PER PLAN
  - ⑤ PROPOSED ODOT 609, CURB, TYPE 6, AS PER PLAN
  - ⑥ TIE-IN AND TRANSITION NEW CURB TO EXISTING CURB/ DRIVEWAY APRON DEPRESSED CURBING, AS PER DETAIL
  - ⑦ TIE-IN AND TRANSITION NEW CURB TO EXISTING ADA RAMP

- ⑧ REPLACE EX. DRIVEWAY APRON WITH 8" REINFORCED CONCRETE APRON, AS PER DETAIL

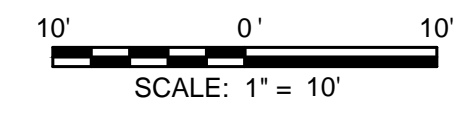

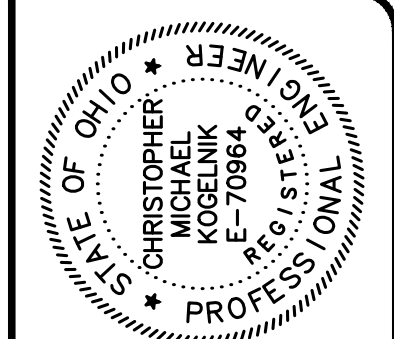

ISSUED FOR:	BID SET:	NO.	REVISION	DATE
07/19/2019	07/19/2019			
AS SHOWN				
DESIGNED BY:	EMS			
DRAWN BY:	EMS			
CHECKED BY:	CMK			

VILLAGE OF LOWELLVILLE  
 WEST WOOD STREET  
 IMPROVEMENTS PROJECT  
 LOWELLVILLE MAHONING COUNTY OHIO  
 SITE IMPROVEMENTS - 03

PROJECT NO.	190074
DISCIPLINE	CIVIL
SHEET NAME	SI-03
SHEET	OF
10	11

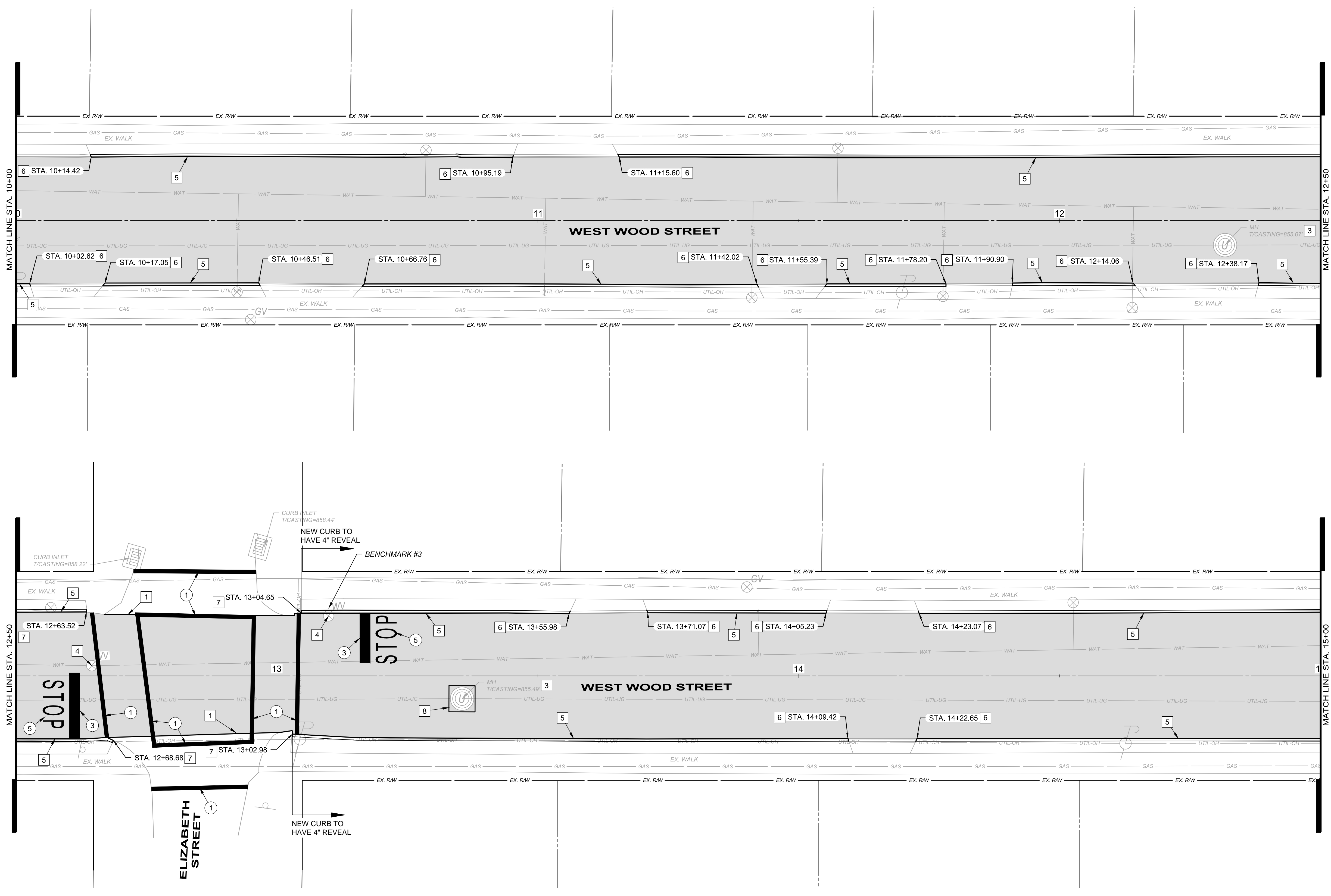

- PAVEMENT MARKING CODED NOTES:
- ① CROSSWALK LINE, 12-INCH WIDE, WHITE, ODOT 643
  - ② CENTER LINE, 4-INCH WIDE, YELLOW, ODOT 643
  - ③ STOP LINE, 24-INCH WIDE, WHITE, ODOT 643
  - ④ DIAGONAL LINE, 12-INCH WIDE, YELLOW, ODOT 643
  - ⑤ WORD ON PAVEMENT, 'STOP', WHITE, ODOT 643

- SITE IMPROVEMENTS CODED NOTES:
- ① LIMITS OF ROADWAY RESURFACING
  - ② INLET ADJUSTED TO GRADE, ODOT 611, AS PER PLAN
  - ③ MANHOLE ADJUSTED TO GRADE, ODOT 611, AS PER PLAN
  - ④ VALVE BOX ADJUSTED TO GRADE, ODOT 638, AS PER PLAN
  - ⑤ PROPOSED ODOT 609, CURB, TYPE 6, AS PER PLAN
  - ⑥ TIE-IN AND TRANSITION NEW CURB TO EXISTING CURB/ DRIVEWAY APRON DEPRESSED CURBING, AS PER DETAIL
  - ⑦ TIE-IN AND TRANSITION NEW CURB TO EXISTING ADA RAMP
  - ⑧ REPLACE EX. CONCRETE BOX-OUT AROUND EX. MANHOLE CASTING, AS PER DETAIL

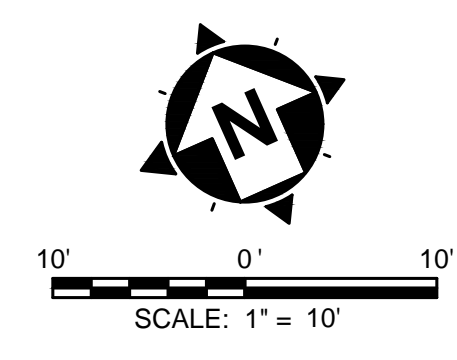

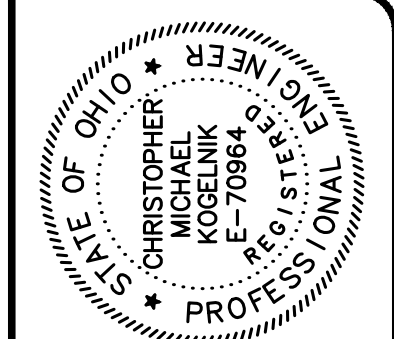

NO	REVISION	DATE

**VILLAGE OF LOWELLVILLE**  
**WEST WOOD STREET**  
**IMPROVEMENTS PROJECT**  
 LOWELLVILLE MAHONING COUNTY OHIO

**SITE IMPROVEMENTS - 04**

PROJECT NO.	190074
DISCIPLINE	CIVIL
SHEET NAME	SI-04
SHEET	11
OF	11

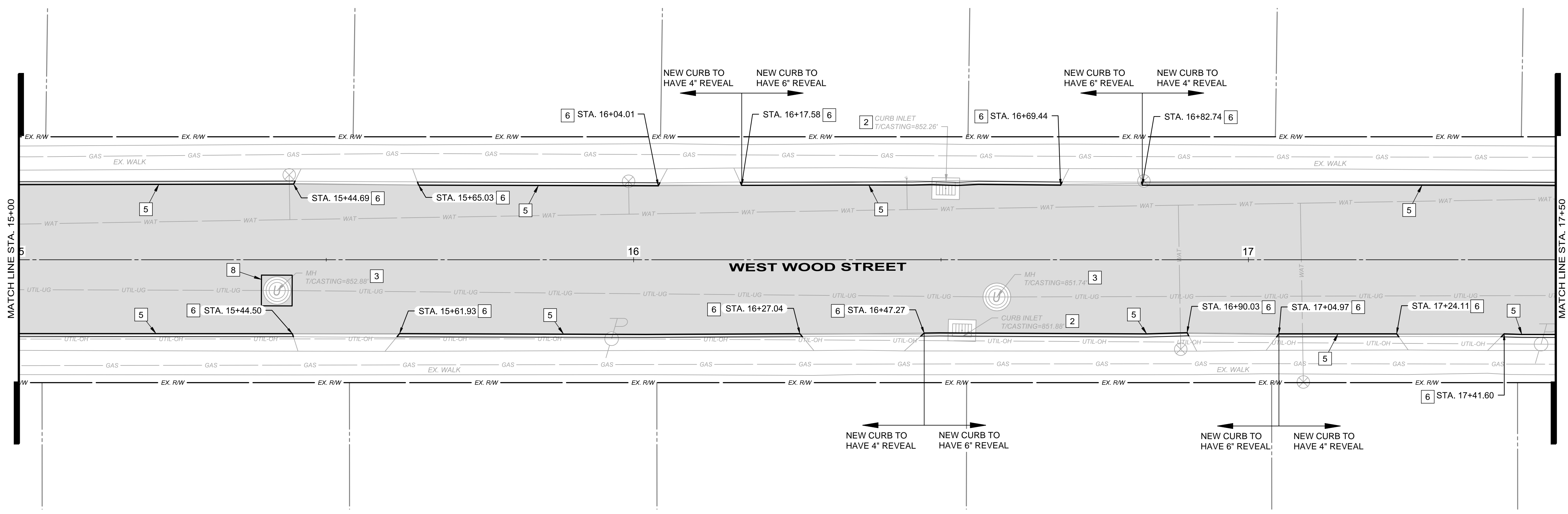

- PAVEMENT MARKING CODED NOTES:**
- ① CROSSWALK LINE, 12-INCH WIDE, WHITE, ODOT 643
  - ② CENTER LINE, 4-INCH WIDE, YELLOW, ODOT 643
  - ③ STOP LINE, 24-INCH WIDE, WHITE, ODOT 643
  - ④ DIAGONAL LINE, 12-INCH WIDE, YELLOW, ODOT 643
  - ⑤ WORD ON PAVEMENT, 'STOP', WHITE, ODOT 643

- SITE IMPROVEMENTS CODED NOTES:**
- ① LIMITS OF ROADWAY RESURFACING
  - ② INLET ADJUSTED TO GRADE, ODOT 611, AS PER PLAN
  - ③ MANHOLE ADJUSTED TO GRADE, ODOT 611, AS PER PLAN
  - ④ VALVE BOX ADJUSTED TO GRADE, ODOT 638, AS PER PLAN
  - ⑤ PROPOSED ODOT 609, CURB, TYPE 6, AS PER PLAN
  - ⑥ TIE-IN AND TRANSITION NEW CURB TO EXISTING CURB/ DRIVEWAY APRON DEPRESSED CURBING, AS PER DETAIL
  - ⑦ TIE-IN AND TRANSITION NEW CURB TO EXISTING ADA RAMP

- ⑧ REPLACE EX. CONCRETE BOX-OUT AROUND EX. MANHOLE CASTING, AS PER DETAIL
- ⑨ NEATLY DEMO. AND REMOVE EX. CONCRETE DRIVEWAY APRON AND DEPRESSED CURBING. EX. SIDEWALK TO REMAIN. RESTORE AREA TO LAWN AND INSTALL TYPE 6 CURBING WITH STANDARD REVEAL.

