

DATE	REVISION	NO	CD	ISSUED FOR	ISSUE DATE	SCALE	DESIGNED BY	DRAWN BY	CHECKED BY
					4/10/20	1/4" = 1'-0"	GMS	GMS	PJF

LAKETRA WICKLIFFE PARK-N-RIDE LOT
 29610 LAKELAND BLVD., WICKLIFFE, OH 44092

BUILDING FOUNDATION PLAN

PROJECT NO.		190065
DISCIPLINE		STRUCTURAL
SHEET NAME		S-04
SHEET	OF	
29	49	

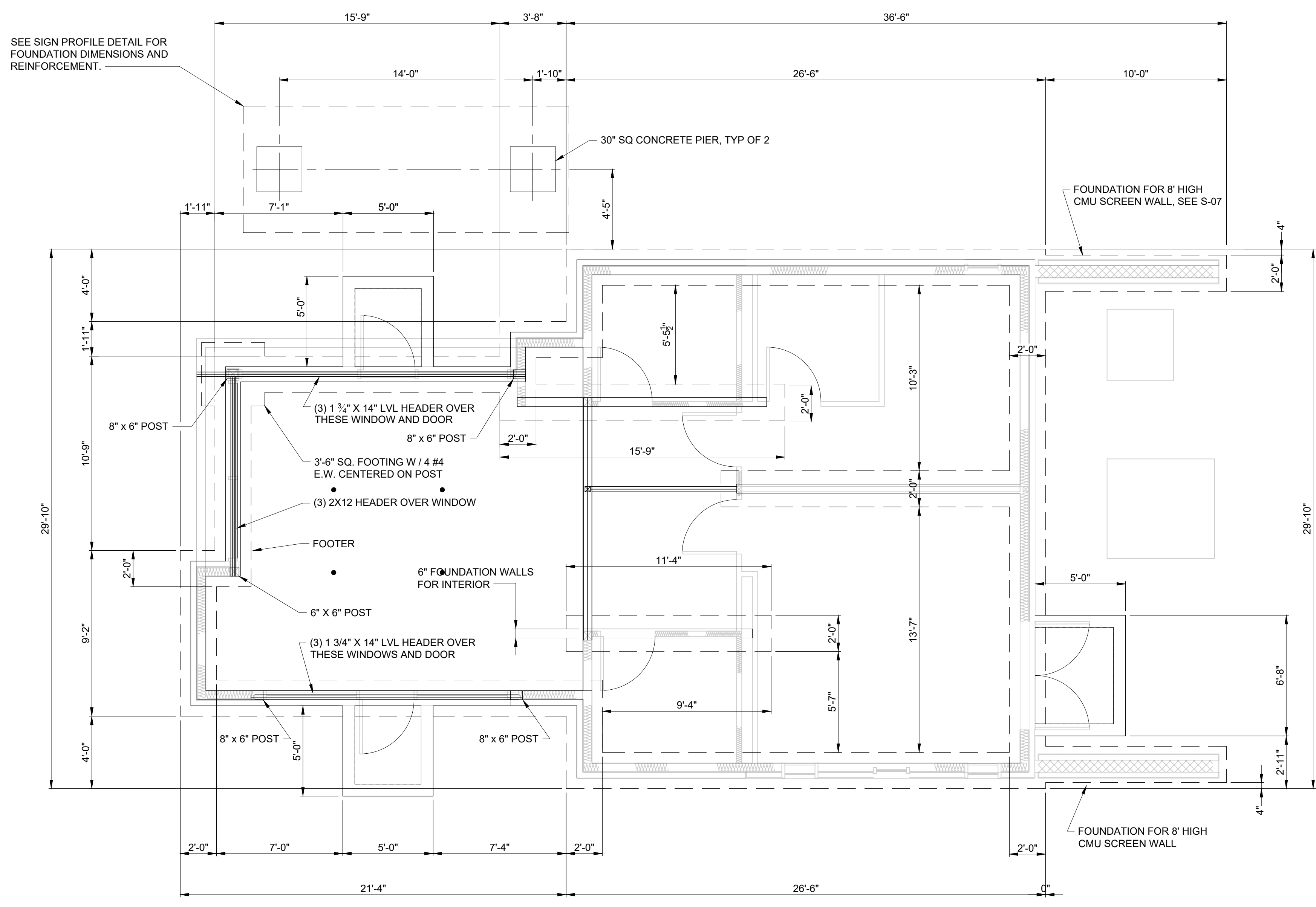
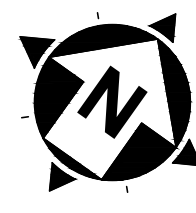

- STRUCTURAL NOTES:**
- WALLS HAVING FOUNDATION AS SHOWN IN THE FOUNDATION PLAN ARE LOAD BEARING WALLS, AND WALLS WITHOUT FOUNDATION ARE NON-LOAD BEARING WALLS.
 - WALL FOOTINGS SHALL BE 2'-0" WIDE X 1'-0" THICK UNO. SEE DETAILS 9 AND 10 ON SHEET S-05.
 - ALL LOAD BEARING WALLS SHALL BE 2" X 6" STUDS @ 12" O.C. UNO. USE DOUBLE 2" X 6" TOP PLATES IN BEARING WALLS.
 - ALL NON-LOAD BEARING WALLS SHALL BE 2" X 4" STUDS @ 16" O.C. UNO.
 - HEADERS OVER OPENINGS IN LOAD BEARING WALLS SPANNING UP TO 4'-0" SHALL BE (3) 2" X 6" UNO. KING STUDS & JACK STUDS AT EACH JAMB SHALL BE (1) 2" X 6" UNO.
 - HEADERS OVER OPENINGS IN INTERIOR NON-LOAD BEARING WALLS SPANNING UP TO 3'-4" SHALL BE (2) 2" X 4" UNO.
 - HEADERS OVER OPENINGS IN INTERIOR NON-LOAD BEARING WALLS SPANNING FROM 3'-4" UP TO 6'-6" SHALL BE (2) 2" X 6" UNO.
 - HEADERS OVER OPENINGS IN LOAD BEARING WALLS SPANNING UP TO 10'-4" SHALL BE (3) 2" X 12" UNO. KING STUDS & JACK STUDS AT EACH JAMB SHALL BE (2)- 2" X 6" UNO.
 - HEADERS SPANNING MORE THAN 11' SHALL BE (3) 1.75" X 14" LVL WITH MINIMUM PROPERTIES OF F_b = 2750 PSI AND E = 1,700,000 PSI.
 - DIMENSIONAL SAWN LUMBER FOR HEADERS, JOISTS AND POSTS SHALL BE SOUTHERN PINE NO. 2 OR BETTER, UNO.
 - STUDS AND WALL TOP PLATES SHALL BE SPRUCE-PINE-FIR NO. 2 OR BETTER, UNO.
 - SILLS BELOW OPENINGS IN LOAD BEARING WALLS SHALL BE 2" X 6" UNO.
 - USE SIMPSON STRONG-TIE CB66 POST BASE AT THE BOTTOM OF 6 X 6 POSTS.
 - USE SIMPSON STRONG-TIE BCS2-3/6 CONNECTOR (POST CAPS) BETWEEN THE BEAMS AND TOPS OF TWO POSTS AT THE NORTH OVERHANG/CANOPY.
 - CRIPPLE STUDS SHALL MATCH THE SIZE AND SPACING OF THE WALL STUDS.
 - REFER TO STRUCTURAL GENERAL NOTES, SPECS, ETC.
 - COORDINATE WITH ARCH, MECH, PLUMBING, ELECTRICAL DRAWINGS FOR OPENINGS AND EMBEDMENTS IN CONCRETE.
 - LOWER FOUNDATION WALL AT DOORWAYS FOR SLAB OVERPOUR. SEE ALSO ARCH. DWGS.
 - GEAR CABINETS SHALL BE ON ISOLATED EQUIPMENT FOUNDATIONS. SEE DETAIL.

FOUNDATION PLAN
 SCALE: 1/4" = 1'-0"