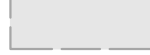

DEMOLITION CODED NOTES:

- 01 NEAT-LINE SAW CUT ROADWAY
- 02 NOT USED
- 03 EXISTING CURB TO BE REPLACED AT ALL LOCATIONS WHERE DAMAGED DURING REMOVAL OF EXISTING STORM SEWER
- 04 DRIVEWAY APRONS
-CONCRETE: REMOVE TO RW OR EXPANSION JOINT
-ASPHALT: REMOVE DRIVEWAY/APRON
-REMOVE: DRIVEWAY/APRON
- 05 SIDEWALK TO BE REMOVED
- 06 CURB TO BE REMOVED

DEMOLITION LEGEND:

-  DENOTES STORM SEWER TO BE REMOVED
-  PAVEMENT TO BE MILLED - MICHAEL LANE STA. 0+06 TO STA. 0+35 LT; STA. 0+35 TO STA. 6+50
ARMAND AVENUE STA. 0+00 TO STA. 10+00
- (TBR) TO BE REMOVED

NOTE:
FULL DEPTH PAVEMENT REPLACEMENT LIMITS - MICHAEL/CARROLL LANE, STA. 0+06 TO STA. 0+35 RT

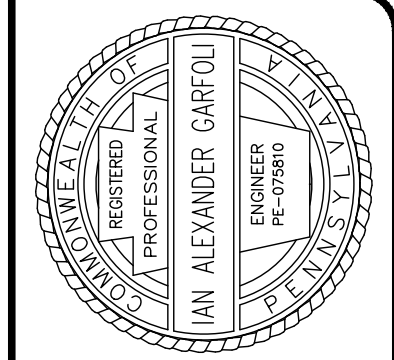
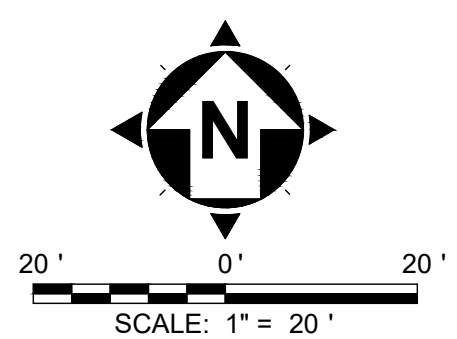
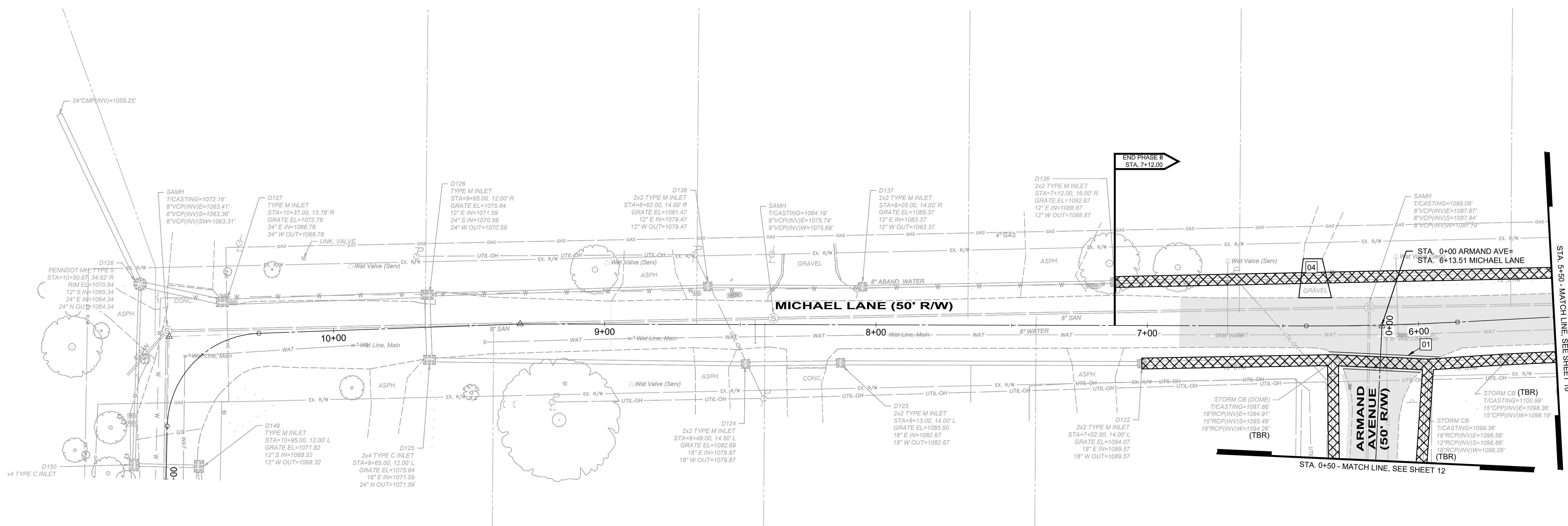

NO	REVISION	DATE

CITY OF HERMITAGE
2020 NEIGHBORHOOD INVESTMENT PROGRAM
MERCER COUNTY HERMITAGE, PENNSYLVANIA
DEMOLITION PLAN
MICHAEL/CARROLL LANE
STA. 5+50 TO STA. 11+00

PROJECT NO.	180302
DISCIPLINE	CIVIL
SHEET NAME	DP-2
SHEET	OF
11	23