

MATCHLINE ~ STA. 7+75

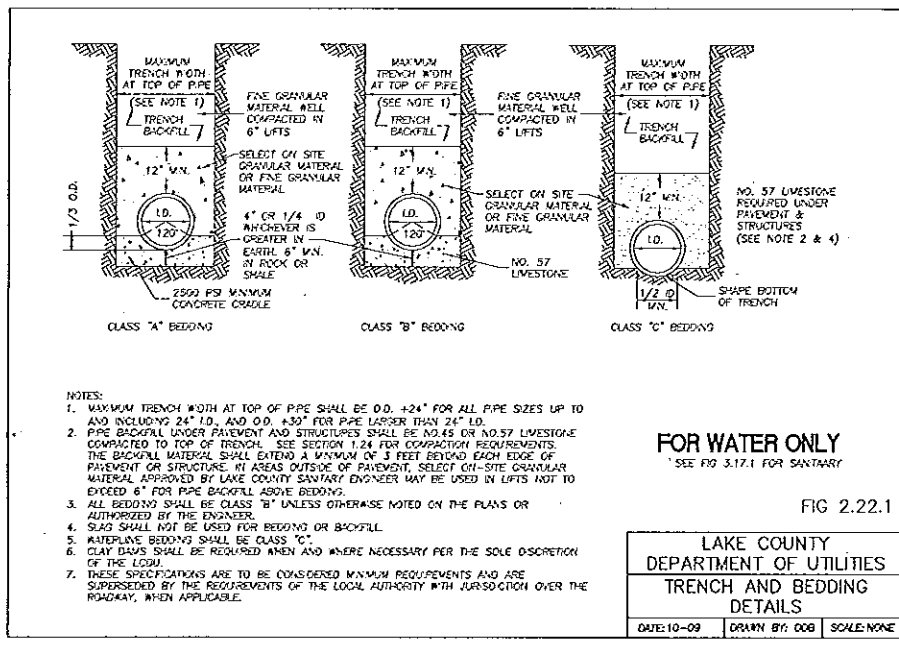
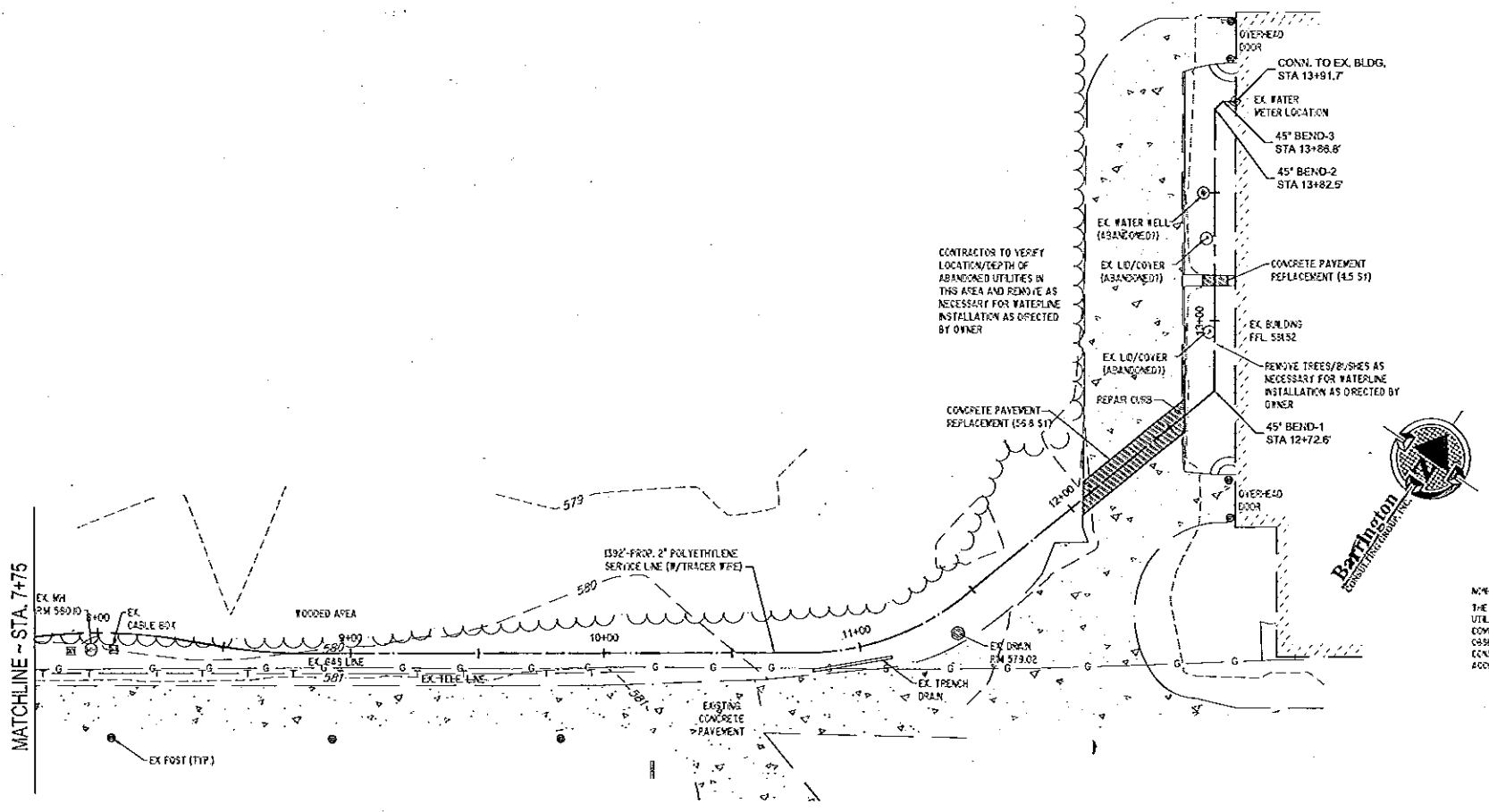

- NOTES:
1. MAXIMUM TRENCH WIDTH AT TOP OF PIPE SHALL BE O.D. +24" FOR ALL PIPE SIZES UP TO AND INCLUDING 24" I.D. AND O.D. +30" FOR PIPE LARGER THAN 24" I.D.
 2. PIPE BACKFILL UNDER PAVEMENT AND STRUCTURES SHALL BE NO. 45 OR NO. 57 LESTONITE COMPACTED TO TOP OF TRENCH. SEE SECTION 1.24 FOR COMPACTION REQUIREMENTS. THE BACKFILL MATERIAL SHALL EXTEND A MINIMUM OF 3 FEET BEYOND EACH EDGE OF PAVEMENT OR STRUCTURE. IN AREAS OUTSIDE OF PAVEMENT, SELECT ON-SITE GRANULAR MATERIAL APPROVED BY LAKE COUNTY SANITARY ENGINEER MAY BE USED IN LIFTS NOT TO EXCEED 6" FOR PIPE BACKFILL ABOVE BEDDING.
 3. ALL BEDDING SHALL BE CLASS "B" UNLESS OTHERWISE NOTED ON THE PLANS OR AUTHORIZED BY THE ENGINEER.
 4. SAND SHALL NOT BE USED FOR BEDDING OR BACKFILL.
 5. WATERLINE BEDDING SHALL BE CLASS "C".
 6. CLAY DAYS SHALL BE REQUIRED WHEN AND WHERE NECESSARY PER THE SOLE DISCRETION OF THE LOCAL.
 7. THESE SPECIFICATIONS ARE TO BE CONSIDERED MINIMUM REQUIREMENTS AND ARE SUPERSEDED BY THE REQUIREMENTS OF THE LOCAL AUTHORITY WITH JURISDICTION OVER THE ROADWAY, WHEN APPLICABLE.

FOR WATER ONLY
 SEE FIG 3.17.1 FOR SANITARY

FIG 2.22.1

LAKE COUNTY
 DEPARTMENT OF UTILITIES
 TRENCH AND BEDDING
 DETAILS

DATE: 10-09 | DRAWN BY: DOB | SCALE: NONE

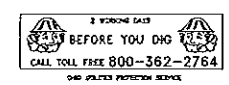

NON-MEMBERS MUST BE CONTACTED DIRECTLY
 THE LOCATION BOTH HORIZONTAL AND VERTICAL OF THE EXISTING UNDERGROUND UTILITIES SHOWN HEREON HAVE BEEN OBTAINED BY A DILIGENT AND COMPREHENSIVE SEARCH OF AVAILABLE RECORDS, VERIFICATION BY FIELD OBSERVATION HAS BEEN CONDUCTED WHERE PRACTICAL, HOWEVER, BARRINGTON CONSULTING GROUP, INC. DOES NOT GUARANTEE THE COMPLETENESS, NOR ACCURACY THEREOF.

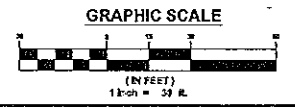
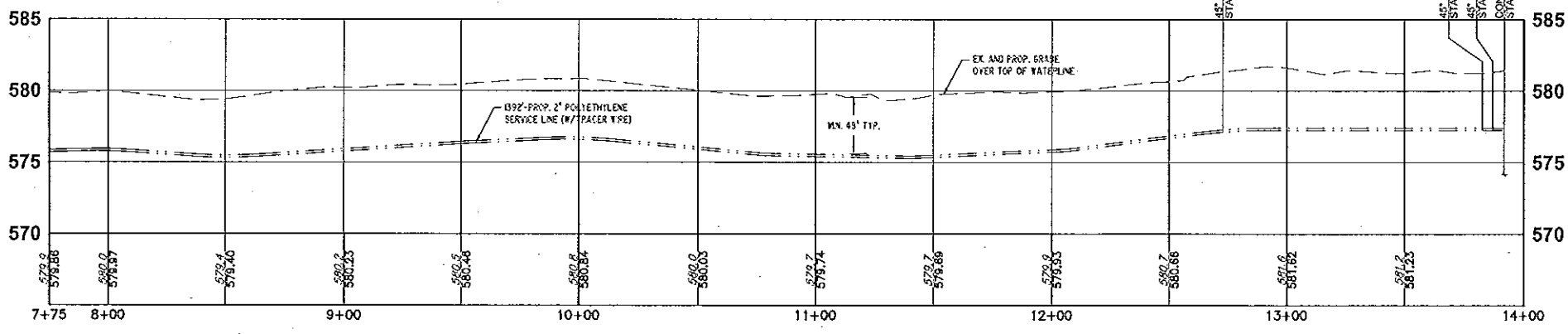

15052

REVISIONS	BY

Barrington
 CONSULTING GROUP, INC.
 9114 TYLER BLVD., MENTOR, OHIO 44060
 PHONE 440.205.1260 FAX 440.205.1262
 www.BarringtonCGI.com

MIDWEST MATERIALS
 MELISSA EVENHIERER
 P.O. BOX 345
 PERRY, OHIO 44081
 PH: 440-259-5200 / FAX: 440-259-5204

2" WATER SERVICE LINE
 MIDWEST MATERIALS STEEL SERVICE CENTER
 3695 SHEPARD ROAD, PERRY, OHIO

SITE PLAN

DRAWN: LKS
 CHECKED: DWN
 DATE: AUGUST 6, 2015
 SCALE: 1" = 30'
 JOB NO: 15052
 SHEET: 2/2

OF SHEETS